



**FITTING INSTRUCTIONS FOR AB0064 ADVENTURE BARS**



**THIS KIT CONTAINS THE ITEMS PICTURED AND LABELLED OVER PAGE.**

SOME PARTS MAY BE SHOWN FOR CLARITY OF INSTRUCTIONS ONLY.

DO NOT PROCEED UNTIL YOU ARE SURE ALL PARTS ARE PRESENT.

**PLEASE READ ALL INSTRUCTIONS BEFORE PROCEEDING.**

**IF IN ANY DOUBT WHEN FITTING OUR PRODUCTS, CONSULT ONE OF OUR DEALERS OR  
HAVE FITTED BY A QUALIFIED TECHNICIAN.**

PLEASE NOTE THAT THE WAY THE KIT IS PACKED DOES NOT NECESSARILY REPRESENT THE WAY OF  
MOUNTING TO THE BIKE.

IN THE EVENT OF RUBBER WASHERS BEING USED TO HOLD COMPONENTS ONTO BOLTS,  
THESE RUBBER WASHERS CAN BE THROWN AWAY.

**DIGITAL COPIES OF THESE INSTRUCTIONS ARE AVAILABLE TO DOWNLOAD FROM**

**[WWW.RG-RACING.COM](http://WWW.RG-RACING.COM)**

R&G

Unit 1, Shelley's Lane, East Worldham, Alton, Hampshire, GU34 3AQ  
Tel: +44 (0)1420 89007 Fax: +44 (0)1420 87301 [www.rg-racing.com](http://www.rg-racing.com) Email: [info@rg-racing.com](mailto:info@rg-racing.com)



<b><u>TOOLS REQUIRED</u></b>	<b><u>GENERAL TORQUE SETTINGS</u></b>
<ul style="list-style-type: none"> <li>• TORX BIT SET &amp; WRENCH</li> <li>• 10MM SPANNER</li> <li>• METRIC ALLEN KEY SET</li> <li>• TORQUE WRENCH</li> <li>• SUITABLE JACK WITH SOFT SUPPORT AREA (TO SUPPORT ENGINE WHILE MOUNTING BOLTS REMOVED).</li> </ul>	<p>M4 BOLT = 8Nm</p> <p>M5 BOLT = 12Nm</p> <p>M6 BOLT = 15Nm</p> <p>M8 BOLT = 20Nm</p> <p>M10 BOLT = 40Nm</p> <p>M12 BOLT = 40Nm</p>

### **LEGEND**

<b>ITEM NO.</b>	<b>DESCRIPTION</b>	<b>QTY</b>
ITEM 1	LHS CRASH BAR ASSEMBLY (AB0064 LHS ASSY)	1
ITEM 2	RHS CRASH BAR ASSEMBLY (AB0064 RHS ASSY)	1
ITEM 3	LHS FRONT SPACER 60mm (S1285)	1
ITEM 4	LHS REAR SPACER 55mm (S1286)	1
ITEM 5	RHS FRONT & REAR SPACER 10mm (S0495)	2
ITEM 6	M12 x 105mm BOLT (LHS FRONT)	1
ITEM 7	M12 x 100mm BOLT (LHS REAR)	1
ITEM 8	M12 x 115mm BOLT (RHS FRONT & REAR)	2
ITEM 9	M12 WASHER	4
ITEM 10	M12 CAP	4

R&G

Unit 1, Shelley's Lane, East Worldham, Alton, Hampshire, GU34 3AQ

Tel: +44 (0)1420 89007 Fax: +44 (0)1420 87301 [www.rg-racing.com](http://www.rg-racing.com) Email: [info@rg-racing.com](mailto:info@rg-racing.com)



**ASSEMBLY DIAGRAM**

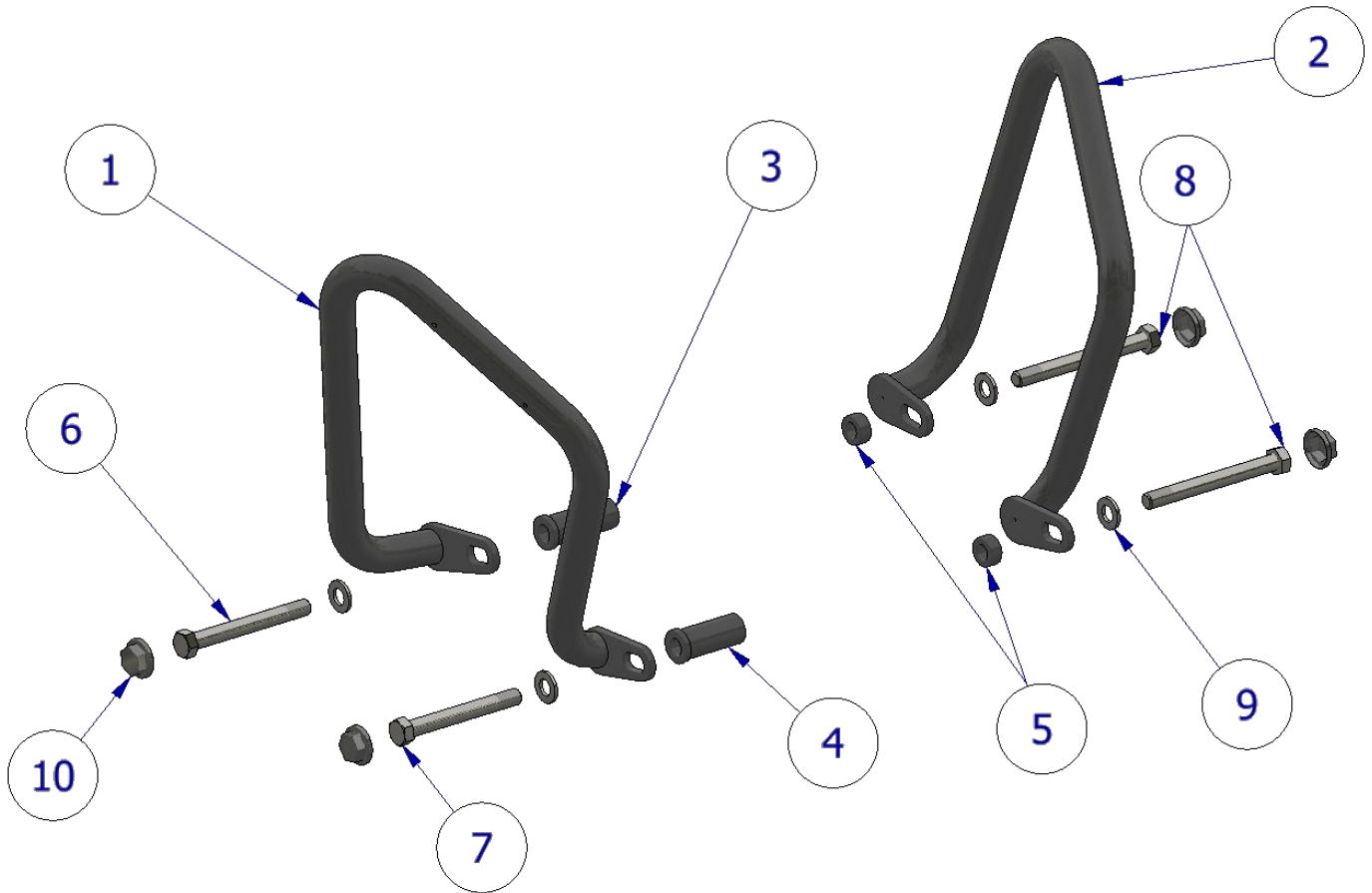

**FITTING PICTURES**



**Picture 1**



**Picture 2**

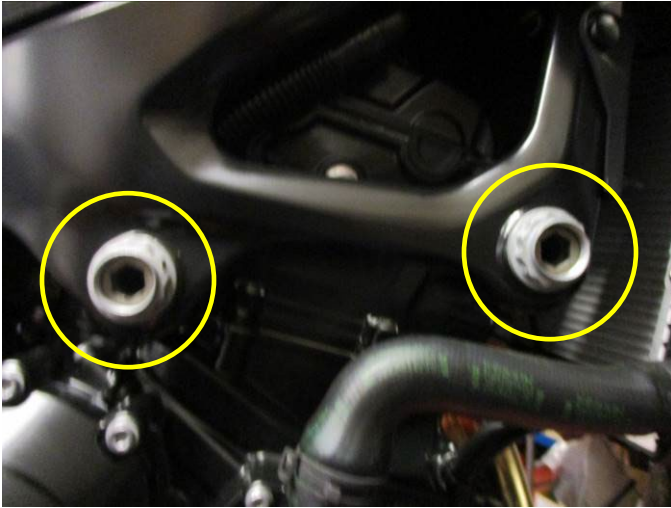

Picture 3

### **FITTING INSTRUCTIONS**

**PLEASE NOTE THAT BEFORE BEGINNING, YOU WILL NEED A SUITABLE JACK TO SUPPORT THE ENGINE WHEN REMOVING OEM ENGINE BOLTS. IF YOU ARE NOT COMFORTABLE CARRYING OUT THIS PROCEDURE, HAVE FITTED BY A QUALIFIED TECHNICIAN. READ ALL STEPS BEFORE PROCEEDING.**

**DO NOT REMOVE ALL 4 ENGINE BOLTS AT ONCE, ONLY REMOVE THE RHS ONCE THE LHS ARE RE-INSTALLED AFTER FITTING THE LHS OF THE KIT.**

- Stand the bike upright and place a jack underneath the engine in a central position and apply a light pressure to the underside of the engine, **NOT** the exhaust or any other tubing. Use a semi soft material (rubber/wood etc) to prevent any damage to the under-side of the engine (example shown in **Picture 1**).
- Remove the LHS OEM upper engine bolts from the locations circled in **Picture 2**.
- Offer up the LHS Adventure bar assembly (**Item 1**) and LHS Spacers (**Items 3 & 4**) as shown in the **Assembly Diagram** and secure in place using the 105mm & 100mm M12 Bolts (**Items 6 & 7**) & 2x M12 washers (**Item 9**).
- Tighten both engine bolts to the correct torque detailed in your service manual.
- Remove the RHS OEM upper engine bolts from the locations circled in **Picture 3**.
- In the same fashion as the LHS – Offer up the RHS crash bar assembly (**Item 2**) and RHS Spacers (**Item 5**) as shown in the **Assembly Diagram** and secure with the 2x 115mm M12 engine bolts (**Item 8**) and 2x remaining washers (**Item 9**).
- Tighten both engine bolts to the correct torque detailed in your service manual.
- Place the M12 Nut caps (**Item 10**) onto the engine bolts.
- Check all bolts are tight and the Adventure bar assembly is secure both sides.

R&G

Unit 1, Shelley's Lane, East Worldham, Alton, Hampshire, GU34 3AQ

Tel: +44 (0)1420 89007 Fax: +44 (0)1420 87301 [www.rg-racing.com](http://www.rg-racing.com) Email: [info@rg-racing.com](mailto:info@rg-racing.com)



**See more R&G products for your Motorcycle in the link below:**

[R&G Racing | All Products for BMW - F900R \(2022\) \(rg-racing.com\)](http://rg-racing.com)

ISSUE 1 – 05/01/2023 (MH)

#### **CONSUMER NOTICE**

The catalogue description and any exhibition of samples are only broad indications of the Products and R&G may make design changes which do not diminish their performance or visual appeal and supplying them in such state shall conform to the order. The Buyer acknowledges no representation or warranty (other than as to title) has been given or will apply to the Products other than those in R&G's order or confirmation and the Buyer confirms it has chosen the Products as being of merchantable quality and suitable for its particular purposes. Where R&G fits the Products or undertakes other services it shall exercise reasonable skill and care and rectify any fault free of charge unless the workmanship has been disturbed. The Buyer is responsible for ensuring that the warranty on the motorcycle is not affected by the fitting of the Products. On return of any defective Products R&G shall at its option either supply a replacement or refund the purchase money but shall not be liable if the Products have been modified or used or maintained otherwise than in accordance with R&G's or manufacturer's instructions and good engineering practice or if the defect arises from accident or neglect. Other than identified above and subject to R&G not limiting its liability for causing death and personal injury, it shall not be liable for indirect or consequential loss and otherwise its liability shall be limited to the amounts paid by the Buyer for the Products or the fitting or service concerned. These terms do not affect the Buyer's statutory rights.

#### **R&G RETURNS POLICY (NON-FAULTY GOODS)**

Returns must be pre-authorized (if not pre-authorized the return will be rejected). Goods may only be returned direct to us if they were purchased direct from us (customer must prove if necessary). Otherwise to be returned to original vendor. Goods must be in re-sellable condition, in the opinion of R&G. All returns are subject to a 25% restocking and handling fee (25% of the gross value exc. P&P – at the prevailing price at time of purchase). The customer must pay any and all carriage charges. No returns of discontinued products, unless within 14 days of purchase. This policy does not affect your statutory rights and does not refer to faulty goods.

R&G

Unit 1, Shelley's Lane, East Worldham, Alton, Hampshire, GU34 3AQ

Tel: +44 (0)1420 89007 Fax: +44 (0)1420 87301 [www.rg-racing.com](http://www.rg-racing.com) Email: [info@rg-racing.com](mailto:info@rg-racing.com)



## **NOTICE DE MONTAGE POUR AB0064 BARRES AVENTURE**



**CE KIT CONTIENT LES ARTICLES ILLUSTRES ET ETIQUETES SUR LA PAGE.**

CERTAINES PARTIES PEUVENT ETRE PRESENTES UNIQUEMENT POUR LA CLARTE DES INSTRUCTIONS.

NE PAS PROCEDER AU MONTAGE TANT QUE VOUS N'ETES PAS SUR QUE TOUTES LES PIECES SOIENT PRESENTES.

**VEUILLEZ LIRE TOUTES LES INSTRUCTIONS AVANT DE CONTINUER.**

**EN CAS DE DOUTE LORS DU MONTAGE DE NOS PRODUITS, CONSULTEZ UN DE NOS  
REVENDEURS OU FAITES APPEL A UN TECHNICIEN QUALIFIÉ.**

VEUILLEZ NOTER QUE LA FAÇON DONT LE KIT EST EMBALLE NE REPRESENTE PAS NECESSAIREMENT LA  
MANIERE DE LE MONTER SUR LA MOTO.

SI DES RONDELLES EN CAOUTCHOUC SONT UTILISEES POUR MAINTENIR LES COMPOSANTS SUR LES  
BOULONS, ELLES PEUVENT ETRE JETEES.

**NOTICE DISPONIBLE AU TELECHARGEMENT SUR :**  
[WWW.RG-RACING.COM](http://WWW.RG-RACING.COM)



<b><u>OUTILS REQUIS</u></b>	<b><u>VALEURS DE SERRAGE</u></b>
<ul style="list-style-type: none"> <li>• CLÉ TORX</li> <li>• CLÉ À MOLETTE 10MM</li> <li>• CLÉS ALLEN</li> <li>• CLÉ DYNAMOMÉTRIQUE</li> <li>• PRISE AVEC ZONE DE SUPPORT SOUPLE (POUR SOUTENIR LE MOTEUR LORSQUE LES BOULONS DE MONTAGE SONT RETIRÉS).</li> </ul>	<p>M4 BOULON = 8Nm</p> <p>M5 BOULON = 12Nm</p> <p>M6 BOULON = 15Nm</p> <p>M8 BOULON = 20Nm</p> <p>M10 BOULON = 40Nm</p> <p>M12 BOULON = 40Nm</p>

### **LÉGENDE**

<b>ARTICLE NO.</b>	<b>DESCRIPTION</b>	<b>QTÉ</b>
ARTICLE 1	ASSEMBLAGE DE PROTECTION CRASH CÔTÉ GAUCHE (AB0064 ASSEMBLAGE CÔTÉ GAUCHE)	1
ARTICLE 2	ASSEMBLAGE DE PROTECTION CRASH CÔTÉ DROIT (AB0064 ASSEMBLAGE CÔTÉ DROIT)	1
ARTICLE 3	ENTRETOISE AVANT GAUCHE 60mm (S1285)	1
ARTICLE 4	ENTRETOISE ARRIÈRE GAUCHE 55mm (S1286)	1
ARTICLE 5	ENTRETOISE AVANT ET ARRIÈRE DROIT 10mm (S0495)	2
ARTICLE 6	M12 x 105mm BOULON (AVANT GAUCHE)	1
ARTICLE 7	M12 x 100mm BOLT (ARRIÈRE GAUCHE)	1
ARTICLE 8	M12 x 115mm BOLT (AVANT & ARRIÈRE DROIT)	2
ARTICLE 9	M12 RONDELLE	4
ARTICLE 10	M12 CAPUCHON	4

R&G

Unit 1, Shelley's Lane, East Worldham, Alton, Hampshire, GU34 3AQ

Tel: +44 (0)1420 89007 Fax: +44 (0)1420 87301 [www.rg-racing.com](http://www.rg-racing.com) Email: [info@rg-racing.com](mailto:info@rg-racing.com)



**SCHÉMA D'ENSEMBLE**

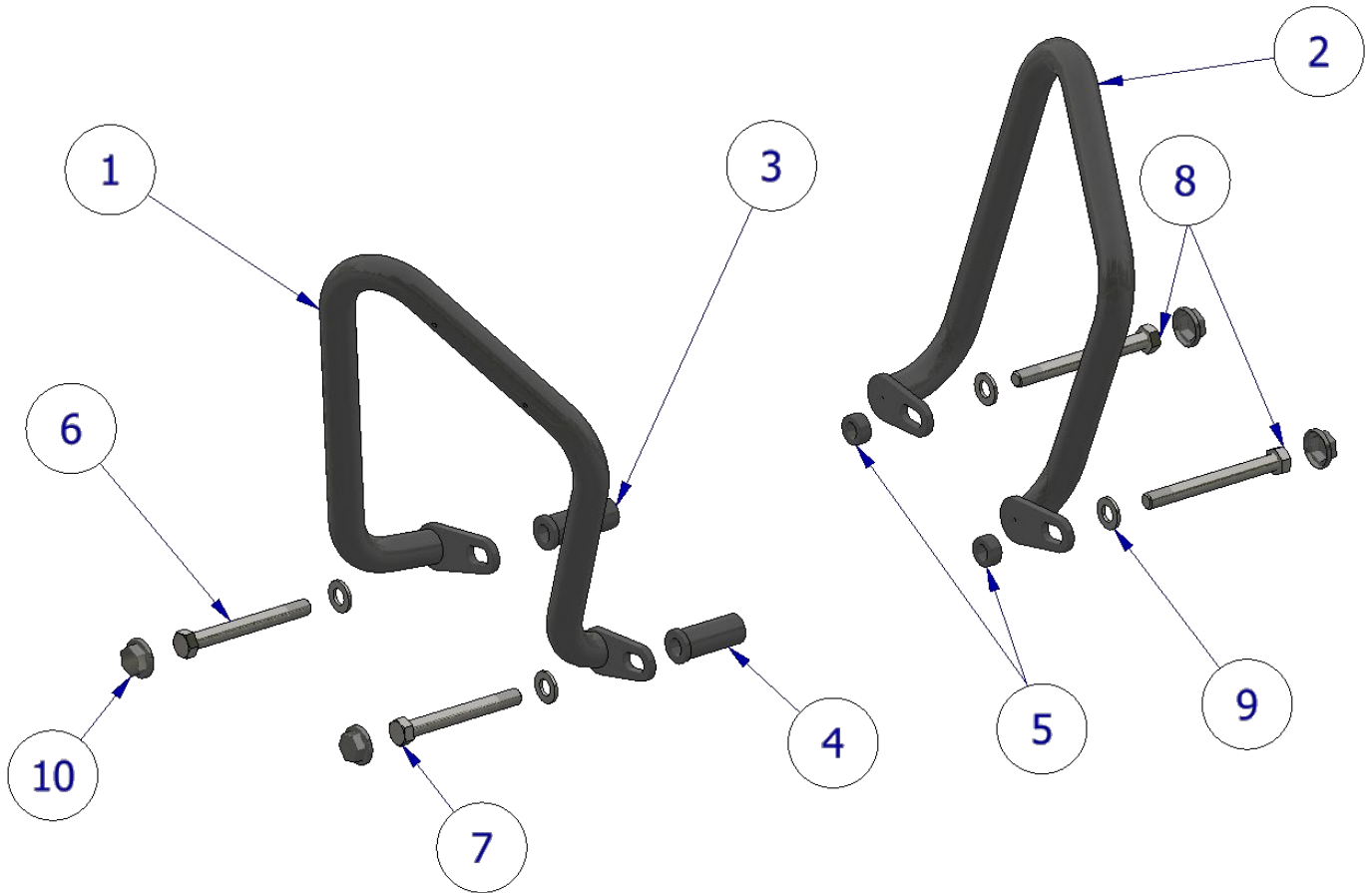

**PHOTOS DE MONTAGE**



**Photo 1**



**Photo 2**



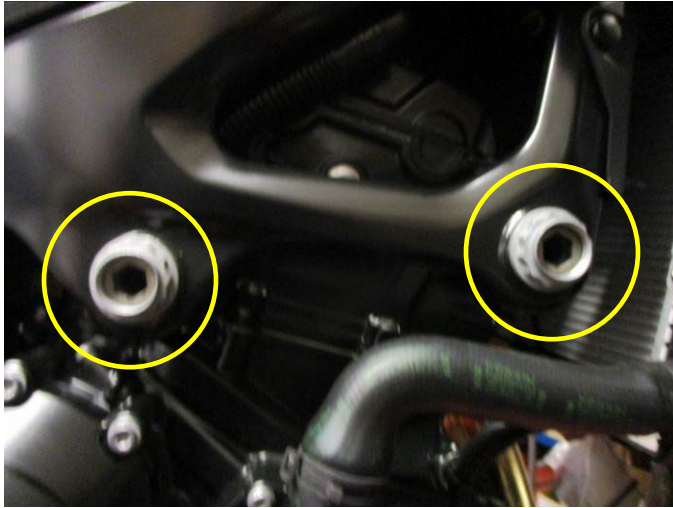

Photo 3

### **NOTICE DE MONTAGE**

**VEUILLEZ NOTER QU'AVANT DE COMMENCER, VOUS AUREZ BESOIN D'UN CRIC APPROPRIÉ POUR SOUTENIR LE MOTEUR LORSQUE VOUS ENLEVEZ LES BOULONS DU MOTEUR D'ORIGINE. SI VOUS N'ÊTES PAS À L'AISE POUR EFFECTUER CETTE MANOEUVRE, FAITES INSTALLER PAR UN TECHNICIEN QUALIFIÉ. LISEZ TOUTES LES ÉTAPES AVANT DE CONTINUER.**

**NE PAS RETIRER LES 4 BOULONS DU MOTEUR À LA FOIS, RETIRER UNIQUEMENT LE CÔTÉ DROIT UNE FOIS QUE LE CÔTÉ GAUCHE EST RÉINSTALLÉ APRÈS LE MONTAGE DU CÔTÉ GAUCHE DU KIT.**

- Mettez la moto debout et placez un cric sous le moteur en position centrale et appliquez une légère pression sur le dessous du moteur, PAS sur l'échappement ou tout autre tube. Utilisez un matériau semi-souple (caoutchouc/bois, etc.) pour éviter tout dommage au-dessous du moteur (exemple montré sur la photo 1).
- Retirez les boulons supérieurs du moteur côté gauche d'origine des emplacements encerclés sur la photo 2.
- Présentez l'ensemble de la barre Adventure côté gauche (article 1) et les entretoises côté gauche (articles 3 et 4) comme indiqué dans le schéma d'assemblage et fixez-les en place à l'aide des boulons M12 de 105 mm et 100 mm (articles 6 et 7) et de 2 rondelles M12 (article 9).
- Serrez les deux boulons du moteur au couple correct indiqué dans votre manuel d'entretien.
- Retirez les boulons supérieurs du moteur côté droit d'origine des emplacements encerclés sur la photo 3.
- De la même manière que le côté gauche - Présentez l'assemblage de la barre côté droit (article 2) et les entretoises côté droit (article 5) comme indiqué sur le schéma d'assemblage et fixez-les avec les 2 boulons de moteur M12 de 115 mm (article 8) et les 2 rondelles restantes (article 9).
- Serrez les deux boulons du moteur au couple correct indiqué dans votre manuel d'entretien.
- Placez les capuchons d'écrou M12 (article 10) sur les boulons du moteur.

R&G

Unit 1, Shelley's Lane, East Worldham, Alton, Hampshire, GU34 3AQ

Tel: +44 (0)1420 89007 Fax: +44 (0)1420 87301 [www.rg-racing.com](http://www.rg-racing.com) Email: [info@rg-racing.com](mailto:info@rg-racing.com)



- Vérifiez que tous les boulons soient serrés et que l'assemblage de la barre Adventure soit sécurisé des deux côtés.

## **Voir plus de produits R&G pour votre moto via ce lien :**

[R&G Racing | All Products for BMW - F900R \(2022\) \(rg-racing.com\)](http://www.rg-racing.com)

ISSUE 1 – 05/01/2023 (MH)

### **CONSUMER NOTICE**

The catalogue description and any exhibition of samples are only broad indications of the Products and R&G may make design changes which do not diminish their performance or visual appeal and supplying them in such state shall conform to the order. The Buyer acknowledges no representation or warranty (other than as to title) has been given or will apply to the Products other than those in R&G's order or confirmation and the Buyer confirms it has chosen the Products as being of merchantable quality and suitable for its particular purposes. Where R&G fits the Products or undertakes other services it shall exercise reasonable skill and care and rectify any fault free of charge unless the workmanship has been disturbed. The Buyer is responsible for ensuring that the warranty on the motorcycle is not affected by the fitting of the Products. On return of any defective Products R&G shall at its option either supply a replacement or refund the purchase money but shall not be liable if the Products have been modified or used or maintained otherwise than in accordance with R&G's or manufacturer's instructions and good engineering practice or if the defect arises from accident or neglect. Other than identified above and subject to R&G not limiting its liability for causing death and personal injury, it shall not be liable for indirect or consequential loss and otherwise its liability shall be limited to the amounts paid by the Buyer for the Products or the fitting or service concerned. These terms do not affect the Buyer's statutory rights.

### **R&G RETURNS POLICY (NON-FAULTY GOODS)**

Returns must be pre-authorized (if not pre-authorized the return will be rejected). Goods may only be returned direct to us if they were purchased direct from us (customer must prove if necessary). Otherwise to be returned to original vendor. Goods must be in re-sellable condition, in the opinion of R&G. All returns are subject to a 25% restocking and handling fee (25% of the gross value exc. P&P – at the prevailing price at time of purchase). The customer must pay any and all carriage charges. No returns of discontinued products, unless within 14 days of purchase. This policy does not affect your statutory rights and does not refer to faulty goods.

R&G

Unit 1, Shelley's Lane, East Worldham, Alton, Hampshire, GU34 3AQ

Tel: +44 (0)1420 89007 Fax: +44 (0)1420 87301 [www.rg-racing.com](http://www.rg-racing.com) Email: [info@rg-racing.com](mailto:info@rg-racing.com)