



FITTING INSTRUCTIONS FOR CP0567 CRASH PROTECTORS



THIS KIT CONTAINS THE ITEMS PICTURED AND LABELLED OVER PAGE.

SOME PARTS MAY BE SHOWN FOR CLARITY OF INSTRUCTIONS ONLY.

DO NOT PROCEED UNTIL YOU ARE SURE ALL PARTS ARE PRESENT.

PLEASE READ ALL INSTRUCTIONS BEFORE PROCEEDING.

**IF IN ANY DOUBT WHEN FITTING OUR PRODUCTS, CONSULT ONE OF OUR DEALERS
OR HAVE FITTED BY A QUALIFIED TECHNICIAN.**

PLEASE NOTE THAT THE WAY THE KIT IS PACKED DOES NOT NECESSARILY REPRESENT THE WAY OF
MOUNTING TO THE BIKE.

IN THE EVENT OF RUBBER WASHERS BEING USED TO HOLD COMPONENTS ONTO BOLTS,
THESE RUBBER WASHERS CAN BE THROWN AWAY.

DIGITAL COPIES OF THESE INSTRUCTIONS ARE AVAILABLE FROM:

WWW.RG-RACING.COM

R&G Racing

Unit 1, Shelley's Lane, East Worldham, Alton, Hampshire, GU34 3AQ

Tel: +44 (0)1420 89007 Fax: +44 (0)1420 87301 www.rg-racing.com Email: info@rg-racing.com



<u>TOOLS REQUIRED</u>	<u>GENERAL TORQUE SETTINGS</u>
<ul style="list-style-type: none"> • SOCKET SET & WRENCH • TORQUE WRENCH (UP TO 40Nm) • SUITABLE BIKE ENGINE SUPPORT JACK • SET OF METRIC ALLEN KEYS • PRY TOOL 	<p>M4 BOLT = 8Nm</p> <p>M5 BOLT = 12Nm</p> <p>M6 BOLT = 15Nm</p> <p>M8 BOLT = 20Nm</p> <p>M10 BOLT = 40Nm</p> <p>M12 BOLT = 40Nm</p>

LEGEND

ITEM NO.	DESCRIPTION	QTY
ITEM 1	CRASH BOBBIN (WITH COMPRESSION SLEEVE FITTED)	2
ITEM 2	MOUNTING BLOCK LHS	1
ITEM 3	MOUNTING BLOCK RHS	1
ITEM 4	SPACER LHS (S1501) 2MM THICK	1
ITEM 5	SPACER LHS (S1502) 14MM THICK	1
ITEM 6	SPACER RHS (S1503) 2.5MM THICK	1
ITEM 7	HEX HEAD BOLT RHS (M10X1.25X70MM)	1
ITEM 8	HEX HEAD BOLT LHS (M10X1.25X60MM)	1
ITEM 9	HEX HEAD BOLT BOTH SIDES (BOBBIN BOLT)	2
ITEM 10	CAP HEAD BOLT BOTH SIDES (M6X1.0X20MM)	2
ITEM 11	SHAKE PROOF WASHER	2
ITEM 12	20MM FLAT WASHER	4
ITEM 13	BOBBIN CAP	2

AERO STYLE CRASH-PROTECTOR ORIENTATION



R&G Racing

Unit 1, Shelley's Lane, East Worldham, Alton, Hampshire, GU34 3AQ

Tel: +44 (0)1420 89007 Fax: +44 (0)1420 87301 www.rg-racing.com Email: info@rg-racing.com



LHS EXPLODED ASSEMBLY VIEW

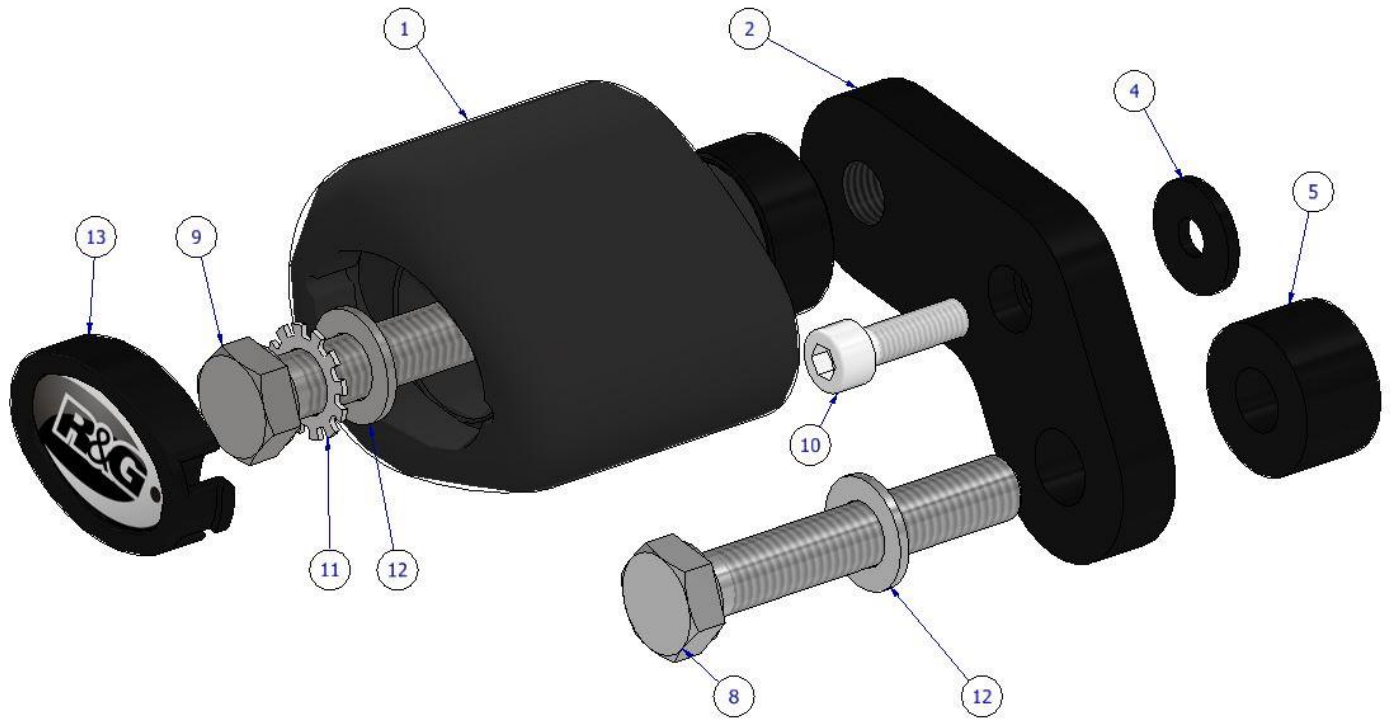

RHS EXPLODED ASSEMBLY VIEW

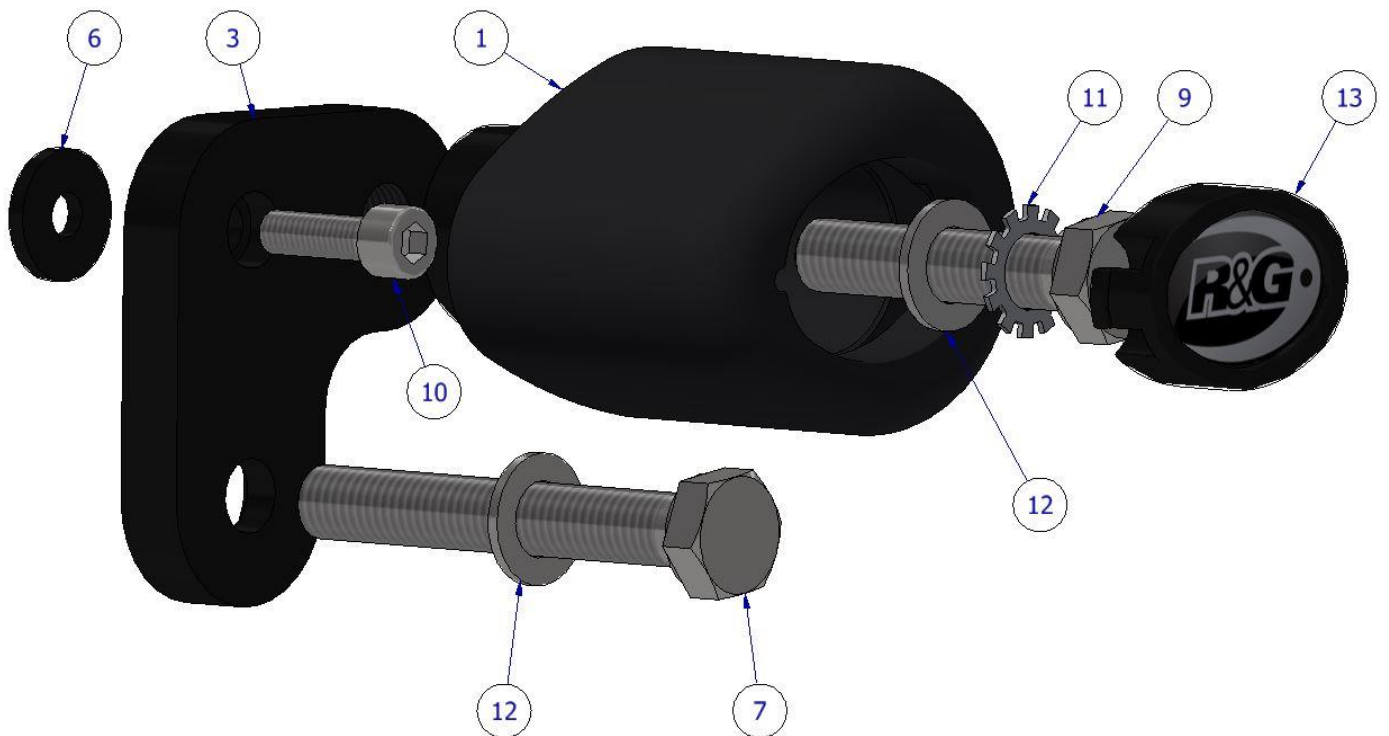



FITTING PICTURES



Picture 1



Picture 2



Picture 3



FITTING INSTRUCTIONS

BEFORE REMOVING ENGINE BOLTS, ENSURE THE BIKE IS UPRIGHT AND SUPPORTED BY A SUITABLE ENGINE STAND OR JACK PLACED UNDER THE SUMP OF THE MOTORBIKE TO SUPPORT THE WEIGHT OF THE ENGINE, THIS WILL PREVENT THE ENGINE FROM MOVING DURING FITTING. ENSURE THE BIKE IS SWITCHED OFF DURING FITTING.

BEFORE FITTING

- Stand the bike upright and support the underside of the engine with a suitable bike jack.
- Throughout the fitting you will need access to both sides of the bike, having an assistant will make the fitting easier.
- Remove the fairings on both sides of the bike.

FITTING THE CRASH PROTECTOR KIT

1. Assemble both sides of the kit without mounting the Bobbin (**ITEM 1**) as shown in the EXPLODED ASSEMBLY VIEW (the Bobbin (**ITEM 1**) will be fitted once the fairings are back on due to fitting location).
2. To fit the assembly's, remove the bolt and thread cap on both sides as circled in **Picture 1**.
3. Align the LHS assembly on the bike as shown in **Picture 2** and tighten both bolts using the **GENERAL TORQUE SETTINGS** on **page 2**.
4. Align the RHS assembly on the bike as shown in **Picture 3** and tighten both bolts using the **GENERAL TORQUE SETTINGS** on **page 2**.
5. Re-fit the fairings on both sides.
6. Now place the Bobbins (**ITEM 1**) onto both assembly's using the bolts (**ITEM 9**), Washers (**ITEM 12**) and locking washers (**ITEM 11**) and tighten using the **GENERAL TORQUE SETTINGS** on **page 2**.
7. Finally pop the bobbin cap (**ITEM 13**) onto the end of both bobbins.
8. Before riding, check both sides are secure, and the crash protectors cannot rotate.
9. Check tightness of the assembly regularly.

ISSUE 1 – 30/01/2024 (JH)

CONSUMER NOTICE

The catalogue description and any exhibition of samples are only broad indications of the Products and R&G may make design changes which do not diminish their performance or visual appeal and supplying them in such state shall conform to the order. The Buyer acknowledges no representation or warranty (other than as to title) has been given or will apply to the Products other than those in R&G's order or confirmation and the Buyer confirms it has chosen the Products as being of merchantable quality and suitable for its particular purposes. Where R&G fits the Products or undertakes other services it shall exercise reasonable skill and care and rectify any fault free of charge unless the workmanship has been disturbed. The Buyer is responsible for ensuring that the warranty on the motorcycle is not affected by the fitting of the Products. On return of any defective Products R&G shall at its option either supply a replacement or refund the purchase money but shall not be liable if the Products have been modified or used or maintained otherwise than in accordance with R&G's or manufacturer's instructions and good engineering practice or if the defect arises from accident or neglect. Other than identified above and subject to R&G not limiting its liability for causing death and personal injury, it shall not be liable for indirect or consequential loss and otherwise its liability shall be limited to the amounts paid by the Buyer for the Products or the fitting or service concerned. These terms do not affect the Buyer's statutory rights.

R&G RACING RETURNS POLICY (NON-FAULTY GOODS)

Returns must be pre-authorized (if not pre-authorized the return will be rejected). Goods may only be returned direct to us if they were purchased direct from us (customer must prove if necessary). Otherwise, to be returned to original vendor. Goods must be in re-sellable condition, in the opinion of R&G Racing. All returns are subject to a 25% restocking and handling fee (25% of the gross value exc. P&P – at the prevailing price at time of purchase). The customer must pay any and all carriage charges. No returns of discontinued products, unless within 14 days of purchase. This policy does not affect your statutory rights and does not refer to faulty goods.

R&G Racing

Unit 1, Shelley's Lane, East Worldham, Alton, Hampshire, GU34 3AQ

Tel: +44 (0)1420 89007 Fax: +44 (0)1420 87301 www.rg-racing.com Email: info@rg-racing.com