



FITTING INSTRUCTIONS FOR EH0103BK
EXHAUST HANGER
MV AGUSTA SUPERVELOCE 800 2020-



THIS KIT CONTAINS THE ITEMS PICTURED AND LABELLED OVER PAGE.

SOME PARTS MAY BE SHOWN FOR CLARITY OF INSTRUCTIONS ONLY.

DO NOT PROCEED UNTIL YOU ARE SURE ALL PARTS ARE PRESENT.

PLEASE READ ALL INSTRUCTIONS BEFORE PROCEEDING.

**IF IN ANY DOUBT WHEN FITTING OUR PRODUCTS, CONSULT ONE OF OUR DEALERS
OR HAVE FITTED BY A QUALIFIED TECHNICIAN.**

PLEASE NOTE THAT THE WAY THE KIT IS PACKED DOES NOT NECESSARILY REPRESENT THE WAY OF
MOUNTING TO THE BIKE.

IN THE EVENT OF RUBBER WASHERS BEING USED TO HOLD COMPONENTS ONTO BOLTS,
THESE RUBBER WASHERS CAN BE THROWN AWAY.

DIGITAL COPIES OF THESE INSTRUCTIONS ARE AVAILABLE FROM:

WWW.RG-RACING.COM



<u>TOOLS REQUIRED</u>	<u>GENERAL TORQUE SETTINGS</u>
<ul style="list-style-type: none"> • METRIC ALLEN TOOL SET • 10mm SPANNER OR SOCKET 	M4 BOLT = 8Nm M5 BOLT = 12Nm M6 BOLT = 15Nm M8 BOLT = 20Nm M10 BOLT = 40Nm M12 BOLT = 40Nm

LEGEND

ITEM NO.	DESCRIPTION	QTY
ITEM 1	HB0103 EXHAUST HANGER	1
ITEM 2	9.5mm SPACER (S01322)	1
ITEM 3	13mm SPACER (S01323)	1
ITEM 4	M6 x 1.00 X 20.00mm BUTTON-HEAD BOLT	1
ITEM 5	M8 x 1.25 X 35.00mm BUTTON-HEAD BOLT	1
ITEM 6	M8 x 1.25 X 30.00mm BUTTON-HEAD BOLT	1
ITEM 7	M6 x 1.00 NYLOC NUT	1
ITEM 8	M6 WASHERS O/D=19mm	2
ITEM 9	M8 WASHERS O/D=19mm	2



EXPLODED ASSEMBLY VIEW

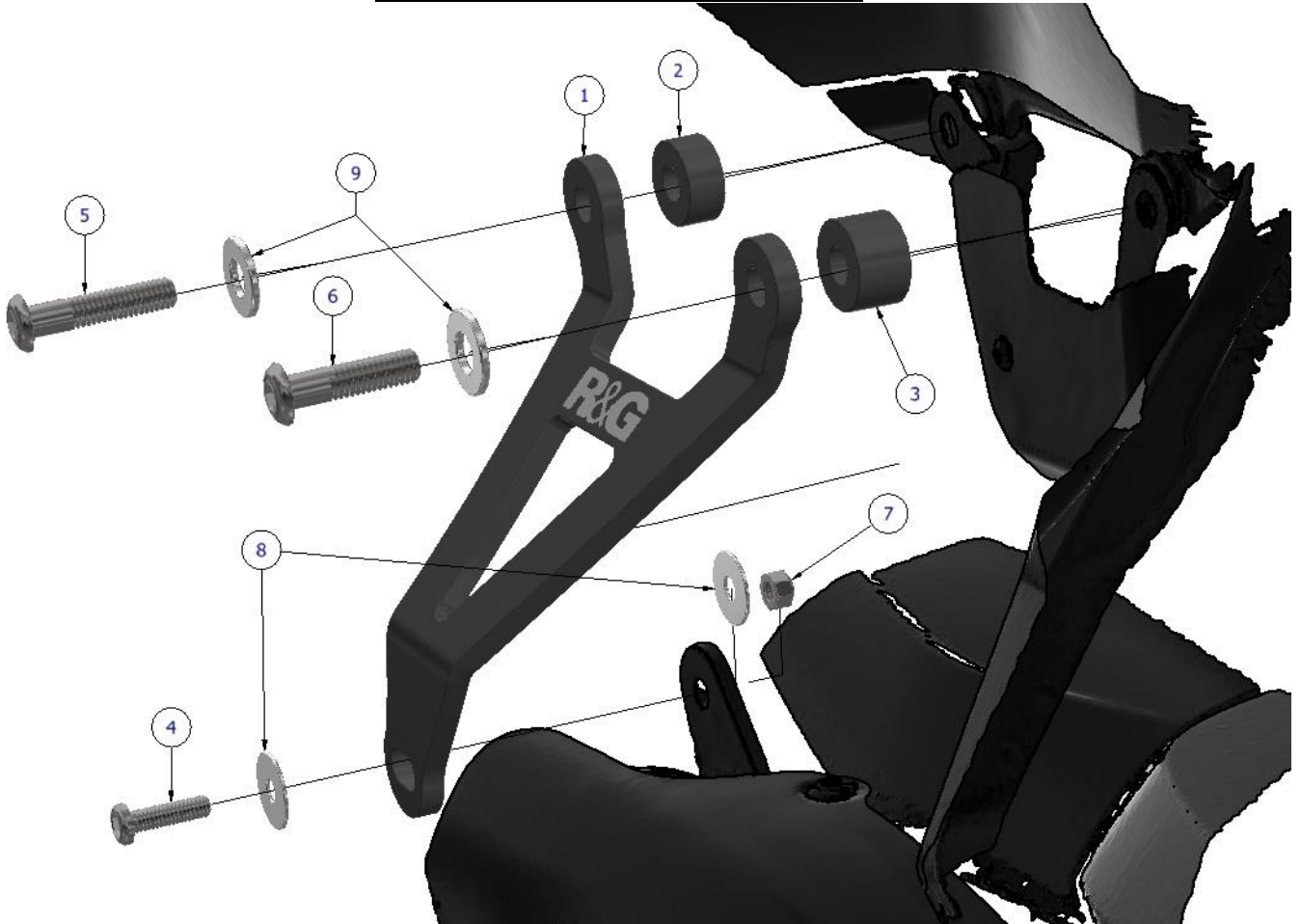

FITTING PICTURES

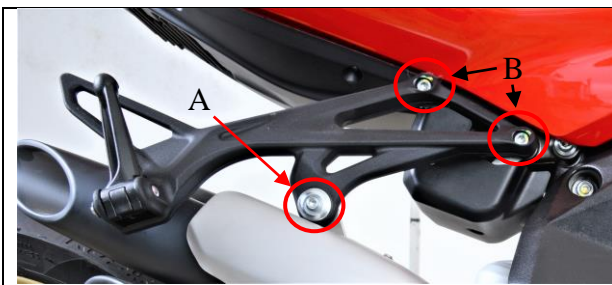

Picture 1

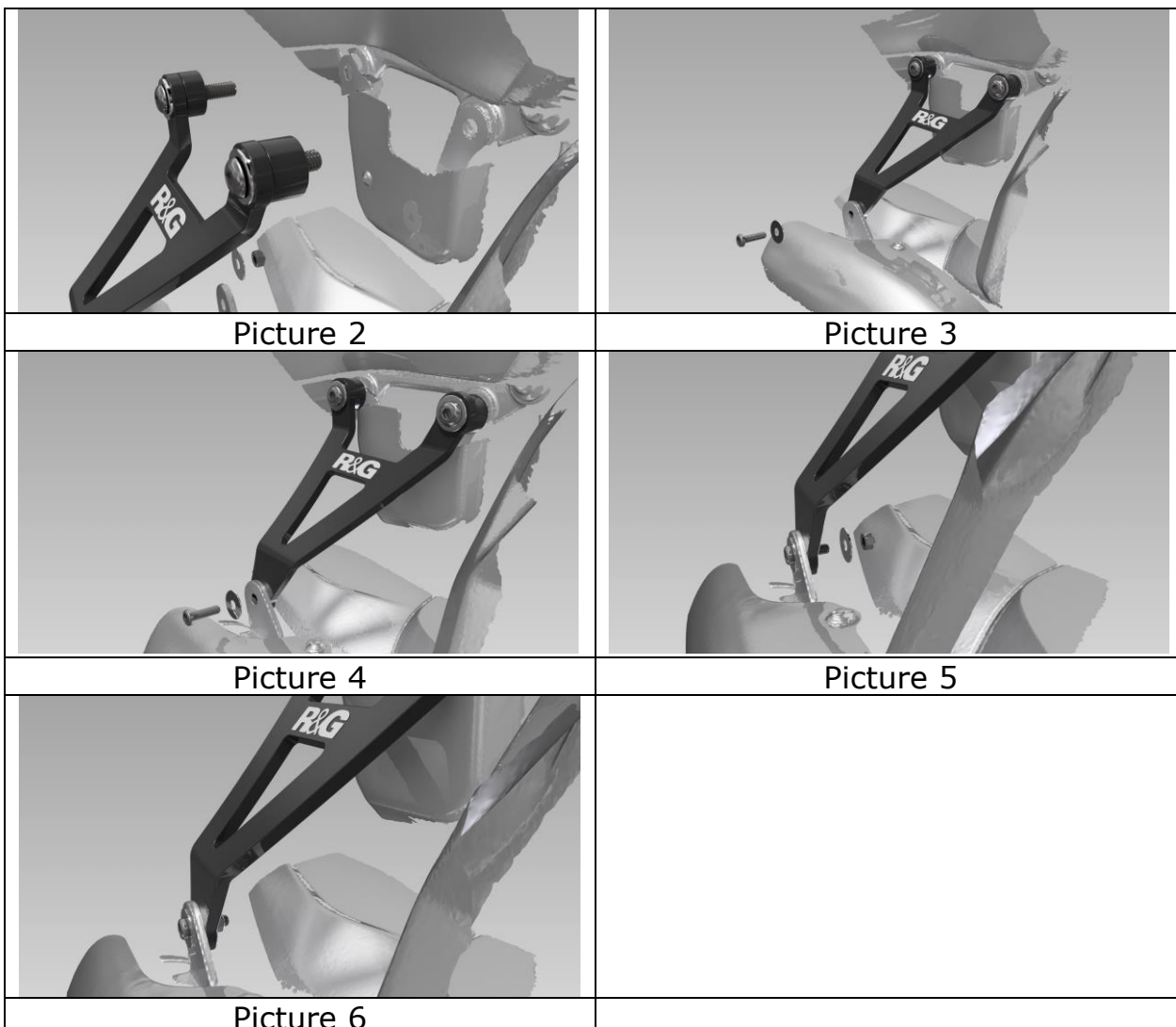

FITTING INSTRUCTIONS

OE EXHAUST HANGER REMOVAL:

- Remove the lower exhaust mounting bolt marked **A** in **Picture 1**.

Note:

The exhaust may drop slightly when the lower mount bolt is removed, this is normal.

- Remove the two upper bracket mounting bolts marked **B** in **Picture 2**.
- Store the OE hanger away safely.

R&G EXHAUST HANGER INSTALLATION:

- Assemble the M8 bolts, washers & spacers with the R&G hanger in the configuration shown in **Picture 2**.
- Offer up the exhaust hanger to the mounting points located on the motorcycle frame & loosely tighten by hand until the hanger can safely hang in place. (**Pictures 3 & 4**)
- Make sure the exhausts mounting tab is in front of the exhaust hanger.
- Slide 1x M6 washer onto the M6 bolt and push through the exhaust bracket then the exhaust hanger. (**Picture 5**)

R&G Racing

Unit 1, Shelley's Lane, East Worldham, Alton, Hampshire, GU34 3AQ

Tel: +44 (0)1420 89007 Fax: +44 (0)1420 87301 www.rg-racing.com Email: info@rg-racing.com



- The assembled components should now stay in position while the remaining washer & M6 Nyloc nut is added to the rear of the lower bolt. (**Pictures 6**)
- Finally, torque all bolts to the required setting and make sure there is no play in the assembly & there is no contact with other parts of the motorcycle.

Please note that it is your responsibility to ensure that no part of the exhaust hanger or exhaust assembly fouls or comes into contact with other parts of the machine. Do not ride the motorcycle until this aspect has been verified and you have compressed the rear suspension (if appropriate to the design of the motorcycle) to test this thoroughly.

ISSUE 1 - 08/04/2021 (TB)

CONSUMER NOTICE

The catalogue description and any exhibition of samples are only broad indications of the Products and R&G may make design changes which do not diminish their performance or visual appeal and supplying them in such state shall conform to the order. The Buyer acknowledges no representation or warranty (other than as to title) has been given or will apply to the Products other than those in R&G's order or confirmation and the Buyer confirms it has chosen the Products as being of merchantable quality and suitable for its particular purposes. Where R&G fits the Products or undertakes other services it shall exercise reasonable skill and care and rectify any fault free of charge unless the workmanship has been disturbed. The Buyer is responsible for ensuring that the warranty on the motorcycle is not affected by the fitting of the Products. On return of any defective Products R&G shall at its option either supply a replacement or refund the purchase money but shall not be liable if the Products have been modified or used or maintained otherwise than in accordance with R&G's or manufacturer's instructions and good engineering practice or if the defect arises from accident or neglect. Other than identified above and subject to R&G not limiting its liability for causing death and personal injury, it shall not be liable for indirect or consequential loss and otherwise its liability shall be limited to the amounts paid by the Buyer for the Products or the fitting or service concerned. These terms do not affect the Buyer's statutory rights.

R&G RACING RETURNS POLICY (NON-FAULTY GOODS)

Returns must be pre-authorized (if not pre-authorized the return will be rejected). Goods may only be returned direct to us if they were purchased direct from us (customer must prove if necessary). Otherwise to be returned to original vendor. Goods must be in re-sellable condition, in the opinion of R&G Racing. All returns are subject to a 25% restocking and handling fee (25% of the gross value exc. P&P – at the prevailing price at time of purchase). The customer must pay any and all carriage charges. No returns of discontinued products, unless within 14 days of purchase. This policy does not affect your statutory rights and does not refer to faulty goods.

R&G Racing

Unit 1, Shelley's Lane, East Worldham, Alton, Hampshire, GU34 3AQ

Tel: +44 (0)1420 89007 Fax: +44 (0)1420 87301 www.rg-racing.com Email: info@rg-racing.com



NOTICE DE MONTAGE POUR EH0103BK
SUPPORT D'ÉCHAPPEMENT
MV AGUSTA SUPERVELOCE 800 2020-



CE KIT CONTIENT LES ARTICLES ILLUSTRÉS ET ÉTIQUETÉS SUR LA PAGE.

CERTAINES PARTIES PEUVENT ÊTRE PRÉSENTES UNIQUEMENT POUR LA CLARTÉ DES INSTRUCTIONS.

NE PAS PROCÉDER AU MONTAGE TANT QUE VOUS N'ÊTES PAS SÛR QUE TOUTES LES PIÈCES SOIENT PRÉSENTES.

VEUILLEZ LIRE TOUTES LES INSTRUCTIONS AVANT DE CONTINUER.

EN CAS DE DOUTE LORS DU MONTAGE DE NOS PRODUITS, CONSULTEZ UN DE NOS REVENDEURS OU FAITES APPEL À UN TECHNICIEN QUALIFIÉ.

VEUILLEZ NOTER QUE LA FAÇON DONT LE KIT EST EMBALLÉ NE REPRÉSENTE PAS NECESSAIREMENT LA MANIÈRE DE LE MONTER SUR LA MOTO.

SI DES RONDELLES EN CAOUTCHOUC SONT UTILISÉES POUR MAINTENIR LES COMPOSANTS SUR LES BOULONS, ELLES PEUVENT ÊTRE JETÉES.

NOTICE DISPONIBLE AU TÉLÉCHARGEMENT SUR : WWW.RG-RACING.COM



<u>OUTILS REQUIS</u>	<u>VALEURS DE SERRAGE</u>
<ul style="list-style-type: none"> • METRIC ALLEN TOOL SET • 10mm SPANNER OR SOCKET 	M4 BOULON = 8Nm M5 BOULON = 12Nm M6 BOULON = 15Nm M8 BOULON = 20Nm M10 BOULON = 40Nm M12 BOULON = 40Nm

LÉGENDE

ARTICLE NO.	DESCRIPTION	QTÉ
ARTICLE 1	HB0103 SUPPORT D'ÉCHAPPEMENT	1
ARTICLE 2	9.5mm ENTRETOISE (S01322)	1
ARTICLE 3	13mm ENTRETOISE (S01323)	1
ARTICLE 4	M6 x 1.00 X 20.00mm BOULON	1
ARTICLE 5	M8 x 1.25 X 35.00mm BOULON	1
ARTICLE 6	M8 x 1.25 X 30.00mm BOULON	1
ARTICLE 7	M6 x 1.00 ÉCROU	1
ARTICLE 8	M6 RONDELLES O/D=19mm	2
ARTICLE 9	M8 RONDELLES O/D=19mm	2



SCHÉMA D'ENSEMBLE

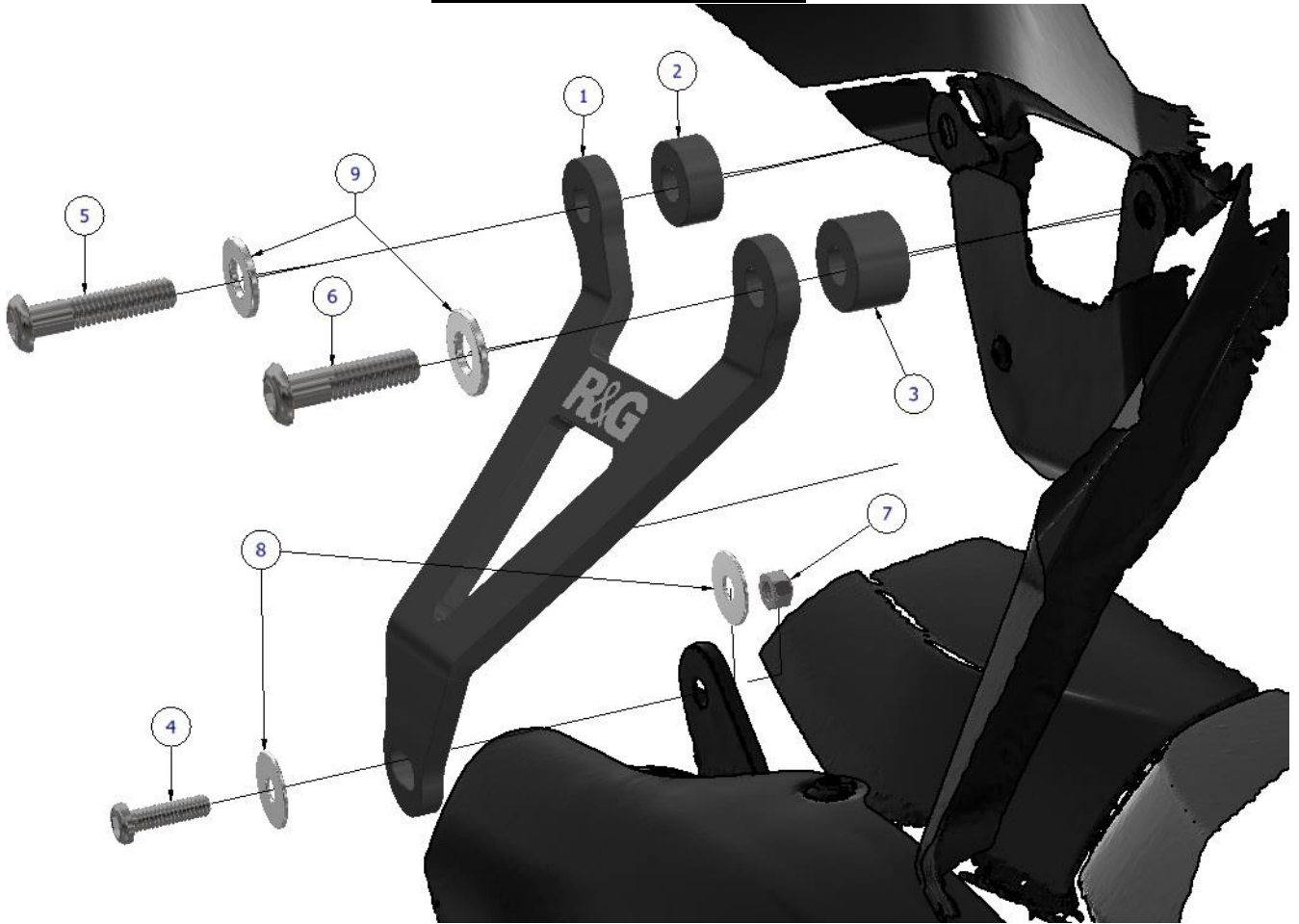

ARTICLES

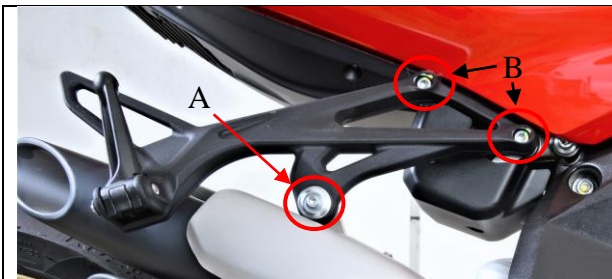

Article 1

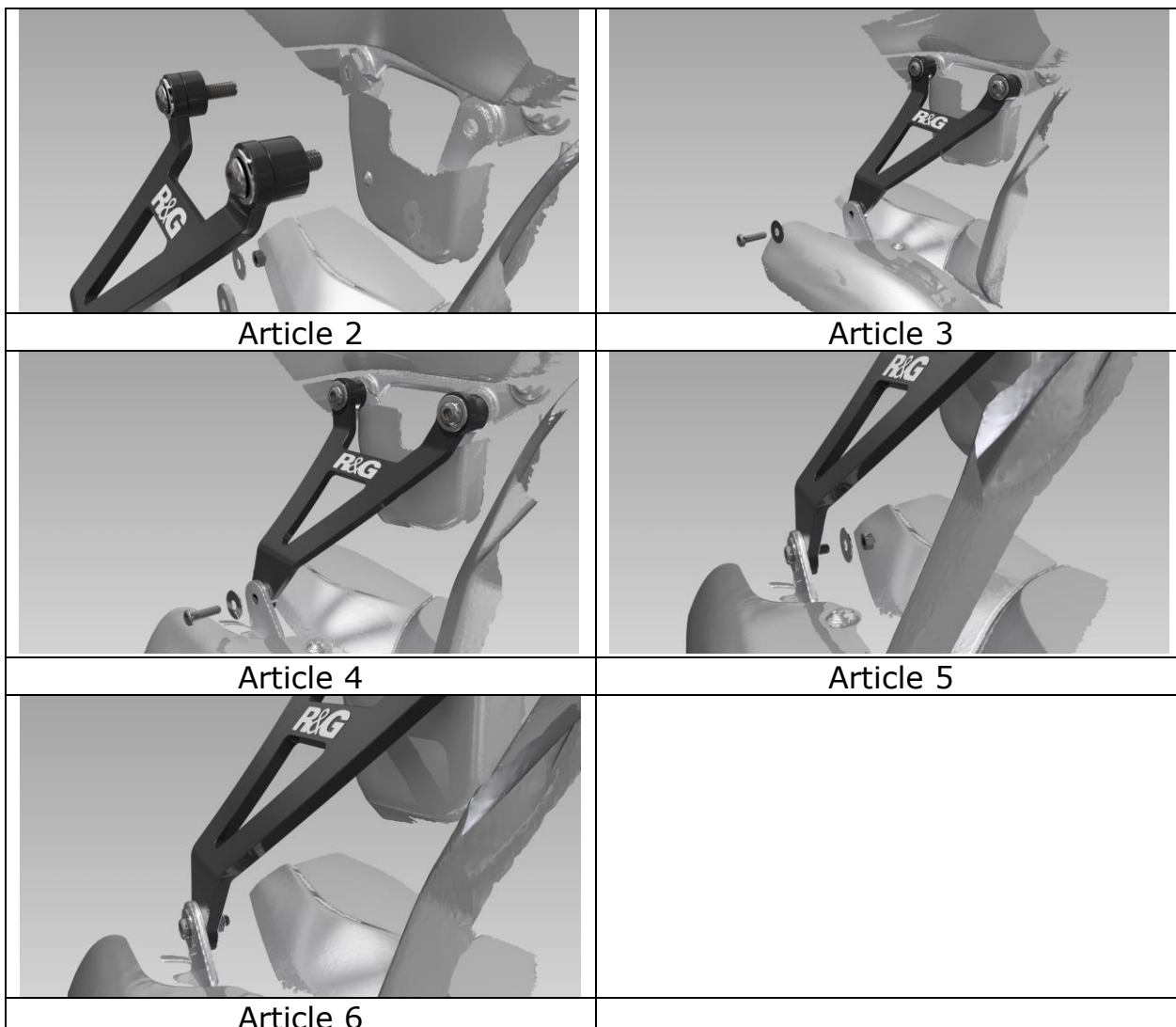

NOTICE DE MONTAGE

ENLEVER LE SUPPORT D'ÉCHAPPEMENT D'ORIGINE:

- Retirez le boulon de fixation d'échappement inférieur marqué A à l'article 1.

Noter:

L'échappement peut légèrement baisser lorsque le boulon de montage inférieur est retiré, c'est normal.

- Retirez les deux boulons de fixation du support supérieur marqués B à l'article 2.
- Rangez le support d'origine en toute sécurité

INSTALLATION DU SUPPORT D'ÉCHAPPEMENT R&G:

- Assemblez les boulons, rondelles et entretoises M8 avec le support R&G dans la configuration indiquée à l'article 2.
- Présentez le crochet d'échappement aux points de montage situés sur le cadre de la moto et serrez légèrement à la main jusqu'à ce que le crochet puisse se bloquer en place en toute sécurité. (Articles 3 et 4)
- Assurez-vous que la languette de montage des échappements se trouve devant le support d'échappement.

R&G Racing

Unit 1, Shelley's Lane, East Worldham, Alton, Hampshire, GU34 3AQ

Tel: +44 (0)1420 89007 Fax: +44 (0)1420 87301 www.rg-racing.com Email: info@rg-racing.com



- Glissez 1 rondelle M6 sur le boulon M6 et poussez à travers le support d'échappement puis le support d'échappement. (Article 5)
- Les composants assemblés doivent maintenant rester en place tandis que la rondelle restante et l'écrou Nyloc M6 sont ajoutés à l'arrière du boulon inférieur. (Articles 6)
- Enfin, serrez tous les boulons au réglage requis et assurez-vous qu'il n'y a pas de jeu dans l'assemblage et qu'il n'y a pas de contact avec les autres pièces de la moto.

Veillez noter qu'il est de votre responsabilité de vous assurer qu'aucune partie du support d'échappement ou de l'ensemble d'échappement ne s'encrasse ou n'entre en contact avec d'autres parties de la machine. Ne conduisez pas la moto tant que cet aspect n'a pas été vérifié et que vous n'avez pas comprimé la suspension arrière (si cela est approprié à la conception de la moto) pour le tester à fond.

ISSUE 1 - 08/04/2021 (TB)

CONSUMER NOTICE

The catalogue description and any exhibition of samples are only broad indications of the Products and R&G may make design changes which do not diminish their performance or visual appeal and supplying them in such state shall conform to the order. The Buyer acknowledges no representation or warranty (other than as to title) has been given or will apply to the Products other than those in R&G's order or confirmation and the Buyer confirms it has chosen the Products as being of merchantable quality and suitable for its particular purposes. Where R&G fits the Products or undertakes other services it shall exercise reasonable skill and care and rectify any fault free of charge unless the workmanship has been disturbed. The Buyer is responsible for ensuring that the warranty on the motorcycle is not affected by the fitting of the Products. On return of any defective Products R&G shall at its option either supply a replacement or refund the purchase money but shall not be liable if the Products have been modified or used or maintained otherwise than in accordance with R&G's or manufacturer's instructions and good engineering practice or if the defect arises from accident or neglect. Other than identified above and subject to R&G not limiting its liability for causing death and personal injury, it shall not be liable for indirect or consequential loss and otherwise its liability shall be limited to the amounts paid by the Buyer for the Products or the fitting or service concerned. These terms do not affect the Buyer's statutory rights.

R&G RACING RETURNS POLICY (NON-FAULTY GOODS)

Returns must be pre-authorized (if not pre-authorized the return will be rejected). Goods may only be returned direct to us if they were purchased direct from us (customer must prove if necessary). Otherwise to be returned to original vendor. Goods must be in re-sellable condition, in the opinion of R&G Racing. All returns are subject to a 25% restocking and handling fee (25% of the gross value exc. P&P – at the prevailing price at time of purchase). The customer must pay any and all carriage charges. No returns of discontinued products, unless within 14 days of purchase. This policy does not affect your statutory rights and does not refer to faulty goods.

R&G Racing

Unit 1, Shelley's Lane, East Worldham, Alton, Hampshire, GU34 3AQ

Tel: +44 (0)1420 89007 Fax: +44 (0)1420 87301 www.rg-racing.com Email: info@rg-racing.com