



FITTING INSTRUCTIONS FOR LP0354
LICENCE PLATE BRACKET



THIS KIT CONTAINS THE ITEMS PICTURED AND LABELLED OVER PAGE.

SOME PARTS MAY BE SHOWN FOR CLARITY OF INSTRUCTIONS ONLY.

DO NOT PROCEED UNTIL YOU ARE SURE ALL PARTS ARE PRESENT.

PLEASE READ ALL INSTRUCTIONS BEFORE PROCEEDING.

**IF IN ANY DOUBT WHEN FITTING OUR PRODUCTS, CONSULT ONE OF OUR DEALERS
OR HAVE FITTED BY A QUALIFIED TECHNICIAN.**

PLEASE NOTE THAT THE WAY THE KIT IS PACKED DOES NOT NECESSARILY REPRESENT THE WAY OF
MOUNTING TO THE BIKE.

IN THE EVENT OF RUBBER WASHERS BEING USED TO HOLD COMPONENTS ONTO BOLTS,
THESE RUBBER WASHERS CAN BE THROWN AWAY.

DIGITAL COPIES OF THESE INSTRUCTIONS ARE AVAILABLE FROM:

WWW.RG-RACING.COM



<u>TOOLS REQUIRED</u>	<u>GENERAL TORQUE SETTINGS</u>
<ul style="list-style-type: none"> • METRIC ALLEN SET • METRIC SOCKET AND WRENCH • PHILLIPS-HEAD SCREWDRIVER 	<p>M4 BOLT = 8Nm</p> <p>M5 BOLT = 12Nm</p> <p>M6 BOLT = 15Nm</p> <p>M8 BOLT = 20Nm</p> <p>M10 BOLT = 40Nm</p> <p>M12 BOLT = 40Nm</p>

LEGEND

ITEM NO.	DESCRIPTION	QTY
ITEM 1	TB0354 - LICENSE PLATE BRACKET	1
ITEM 2	LA0002 - LICENSE PLATE ILLUMINATOR	1
ITEM 3	CON0007 - LICENSE PLATE ILLUMINATOR CONNECTOR	1
ITEM 4	M6 x 1.00 x 20mm BUTTON HEAD BOLT	4
ITEM 5	M6 x 12mm OD WASHER	4
ITEM 6	666-896-18 - 180mm LENGTH OF HEAT SHRINK	1
ITEM 7	CT75 - 75mm LONG CABLE TIE	6
ITEM 8	RB0010 - RUBBER BUNG	1
ITEM 9	REFL3 - REFLECTOR	1



ASSEMBLY DIAGRAM

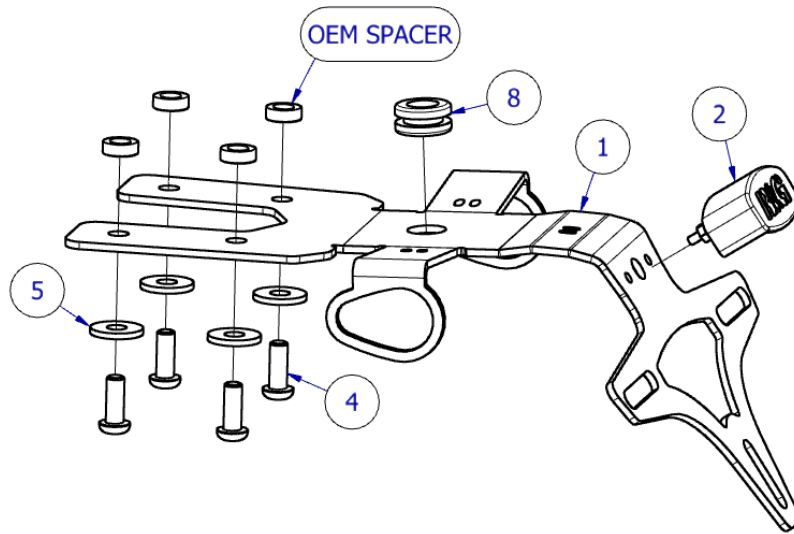

FITTING PICTURES

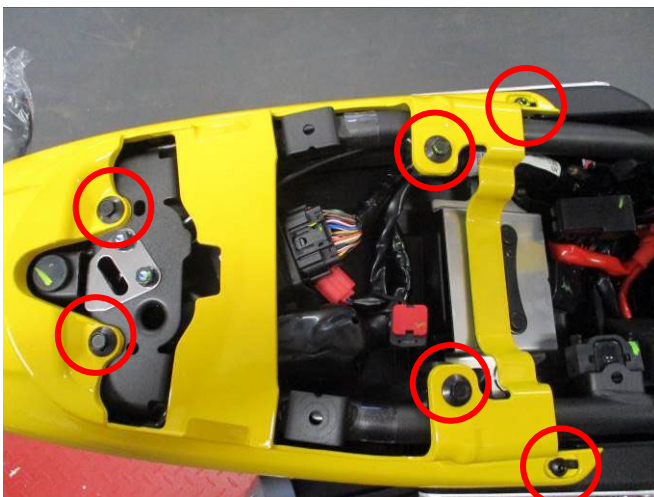

Picture 1

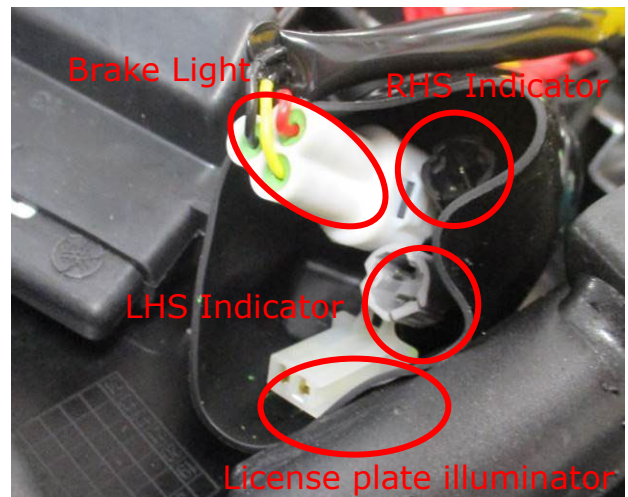

Picture 2

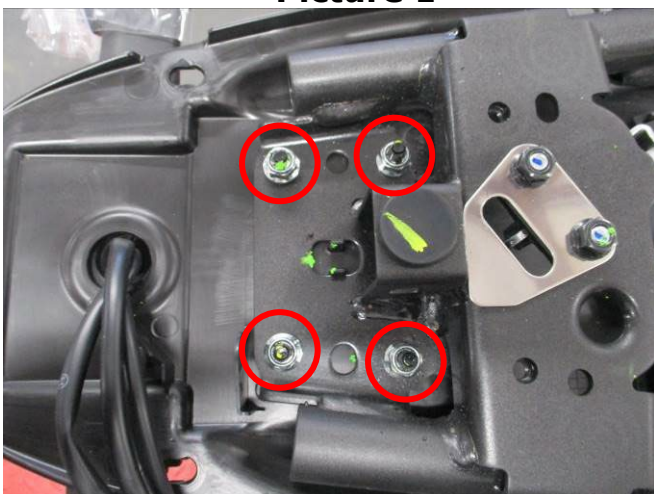

Picture 3

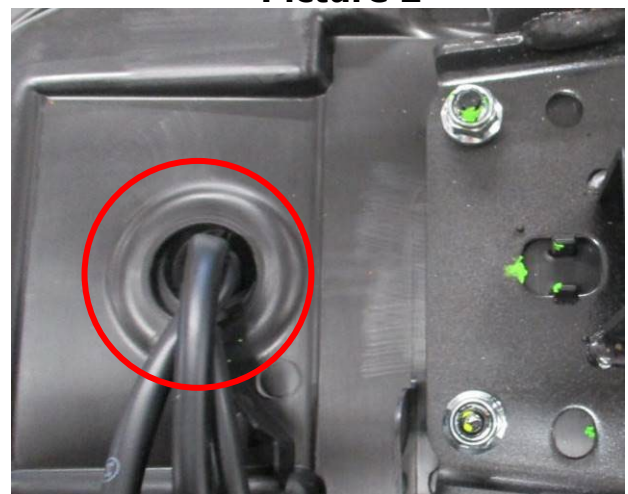

Picture 4



FITTING INSTRUCTIONS

- Begin by removing the passenger seat using the key.
- Remove the bolts securing the top of the tail fairing to the bike as shown in **Picture 1** and also carefully whilst holding the tail fairing to stop it from falling, remove the 4 x black screws from the underside of the tail to separate and remove the fairing from the bike.
- Now, with the tail ready to be lifted away, disconnect the 4 connectors highlighted in **Picture 2**.
- Remove the 4 x locking nuts as shown in **Picture 3** and carefully remove the OEM license plate bracket from the bike.
- Keep the 4 x OEM spacers safely to one side which are used to mount the OEM license plate bracket to the bike.
- Referring to the **ASSEMBLY DIAGRAM** above, pre-assemble the R&G Tail Tidy (**ITEM 1**) by attaching your OEM indicators to the bike along with the provided license plate illuminator (**ITEM 2**) and also the rubber bung to protect cables (**ITEM 8**).
- Thread the indicator cables along with the LA0002 cable through the rubber lined hole in the R&G Tail Tidy as shown in **Picture 4**.
- Protect the LA0002 wires by using the provided heat shrink (**ITEM 6**).
- Attach the provided license plate illuminator connector (**ITEM 3**).
- Tidy up all cables using the provided cable ties (**ITEM 7**) and slotted holes provided in the license plate bracket.
- Secure the R&G Tail Tidy to the bike using the bolts and washers provided (**ITEMS 4 & 5**) as shown in **ASSEMBLY DIAGRAM**, re-use the OEM spacers and locking nuts to attach to the bike.
- Check that the indicators and license plate illuminator are wired correctly and operating as they should before re-installing the tail fairing and seat.

IMPORTANT: IF FITTING A FULL-SIZE LICENCE PLATE AND PLACING IT FAR DOWN ON THE LICENCE PLATE HANGER, THERE IS A SMALL CHANCE OF THE LICENCE PLATE HITTING THE BACK WHEEL UNDER HEAVY LOAD AND OVER LARGE BUMPS IN THE ROAD. IT IS YOUR RESPONSIBILITY TO CHECK FOR THIS POSSIBILITY AND TAKE AVOIDING ACTION. FAILURE TO CHECK THIS COULD RESULT IN SERIOUS INJURY.

See more R&G products for your Motorcycle in the links below:

[R&G Racing | All Products for Yamaha - XSR125 \(2021\) \(rg-racing.com\)](http://www.rg-racing.com)

ISSUE 1 – 24/02/2023 - (AO)

CONSUMER NOTICE

The catalogue description and any exhibition of samples are only broad indications of the Products and R&G may make design changes which do not diminish their performance or visual appeal and supplying them in such state shall conform to the order. The Buyer acknowledges no representation or warranty (other than as to title) has been given or will apply to the Products other than those in R&G's order or confirmation and the Buyer confirms it has chosen the Products as being of merchantable quality and suitable for its particular purposes. Where R&G fits the Products or undertakes other services it shall exercise reasonable skill and care and rectify any fault free of charge unless the workmanship has been disturbed. The Buyer is responsible for ensuring that the warranty on the motorcycle is not affected by the fitting of the Products. On return of any defective Products R&G shall at its option either supply a replacement or refund the purchase money but shall not be liable if the Products have been modified or used or maintained otherwise than in accordance with R&G's or manufacturer's instructions and good engineering practice or if the defect arises from accident or neglect. Other than identified above and subject to R&G not limiting its liability for causing death and personal injury, it shall not be liable for indirect or consequential loss and otherwise its liability shall be limited to the amounts paid by the Buyer for the Products or the fitting or service concerned. These terms do not affect the Buyer's statutory rights.

R&G RACING RETURNS POLICY (NON-FAULTY GOODS)

Returns must be pre-authorized (if not pre-authorized the return will be rejected). Goods may only be returned direct to us if they were purchased direct from us (customer must prove if necessary). Otherwise to be returned to original vendor. Goods

R&G Racing

Unit 1, Shelley's Lane, East Worldham, Alton, Hampshire, GU34 3AQ

Tel: +44 (0)1420 89007 Fax: +44 (0)1420 87301 www.rg-racing.com Email: info@rg-racing.com



must be in re-sellable condition, in the opinion of R&G Racing. All returns are subject to a 25% restocking and handling fee (25% of the gross value exc. P&P – at the prevailing price at time of purchase). The customer must pay any and all carriage charges. No returns of discontinued products, unless within 14 days of purchase. This policy does not affect your statutory rights and does not refer to faulty goods.

R&G Racing

Unit 1, Shelley's Lane, East Worldham, Alton, Hampshire, GU34 3AQ

Tel: +44 (0)1420 89007 Fax: +44 (0)1420 87301 www.rg-racing.com Email: info@rg-racing.com



NOTICE DE MONTAGE POUR LP0354
SUPPORT DE PLAQUE



CE KIT CONTIENT LES ARTICLES ILLUSTRÉS ET ÉTIQUETES SUR LA PAGE.

CERTAINES PARTIES PEUVENT ÊTRE PRÉSENTES UNIQUEMENT POUR LA CLARTÉ DES INSTRUCTIONS.

NE PAS PROCÉDER AU MONTAGE TANT QUE VOUS N'ÊTES PAS SÛR QUE TOUTES LES PIÈCES SOIENT PRÉSENTES.

VEUILLEZ LIRE TOUTES LES INSTRUCTIONS AVANT DE CONTINUER.

EN CAS DE DOUTE LORS DU MONTAGE DE NOS PRODUITS, CONSULTEZ UN DE NOS REVENDEURS OU FAITES APPEL À UN TECHNICIEN QUALIFIÉ.

VEUILLEZ NOTER QUE LA FAÇON DONT LE KIT EST EMBALLÉ NE REPRÉSENTE PAS NECESSAIREMENT LA MANIÈRE DE LE MONTER SUR LA MOTO.

SI DES RONDELLES EN CAOUTCHOUC SONT UTILISÉES POUR MAINTENIR LES COMPOSANTS SUR LES BOULONS, ELLES PEUVENT ÊTRE JETÉES.

NOTICE DISPONIBLE AU TÉLÉCHARGEMENT SUR : WWW.RG-RACING.COM

R&G Racing

Unit 1, Shelley's Lane, East Worldham, Alton, Hampshire, GU34 3AQ

Tel: +44 (0)1420 89007 Fax: +44 (0)1420 87301 www.rg-racing.com Email: info@rg-racing.com



<u>OUTILS REQUIS</u>	<u>VALEURS DE SERRAGE</u>
<ul style="list-style-type: none"> • CLÉS ALLEN • CLÉ À CLIQUET + DOUILLE • CLÉ À MOLETTE 	M4 BOULON = 8Nm M5 BOULON = 12Nm M6 BOULON = 15Nm M8 BOULON = 20Nm M10 BOULON = 40Nm M12 BOULON = 40Nm

LÉGENDE

ARTICLE NO.	DESCRIPTION	QTÉ
ARTICLE 1	TB0354 - SUPPORT DE PLAQUE	1
ARTICLE 2	LA0002 - FEU DE PLAQUE	1
ARTICLE 3	CON0007 - CONNECTEUR DE FEU DE PLAQUE	1
ARTICLE 4	M6 x 1.00 x 20mm BOULON	4
ARTICLE 5	M6 x 12mm RONDELLE	4
ARTICLE 6	666-896-18 - 180mm MANCHON THERMO RÉTRACTABLE	1
ARTICLE 7	CT75 - 75mm COLLIER DE SERRAGE	6
ARTICLE 8	RB0010 - BOUCHON EN CAOUTCHOUC	1
ARTICLE 9	REFL3 - RÉFLECTEUR	1



SCHÉMA D'ASSEMBLAGE

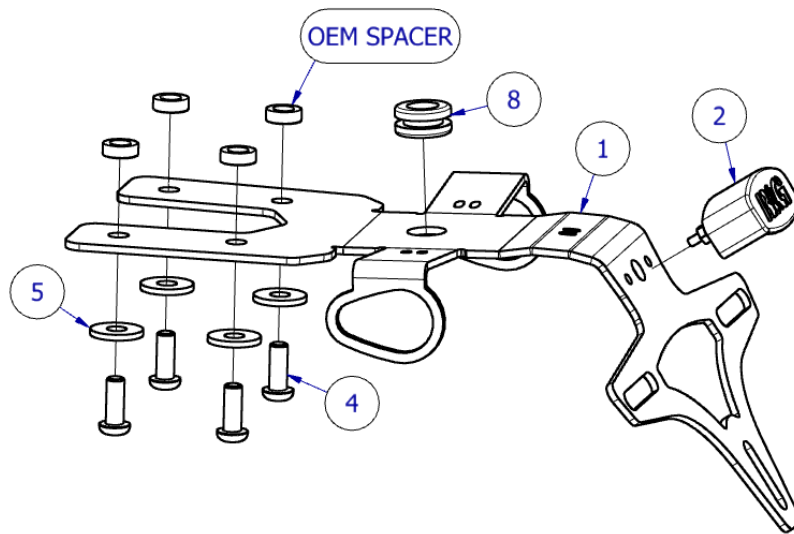

PHOTOS DE MONTAGE

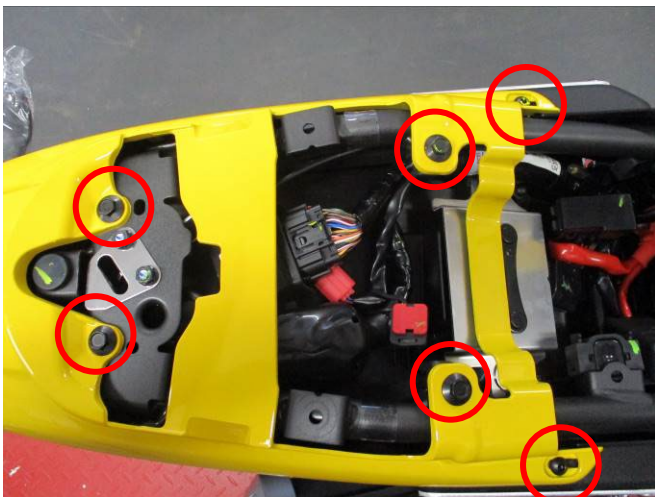

Photo 1

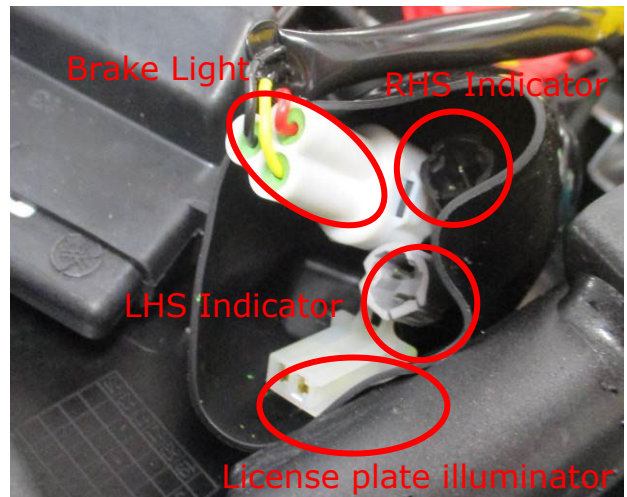

Photo 2

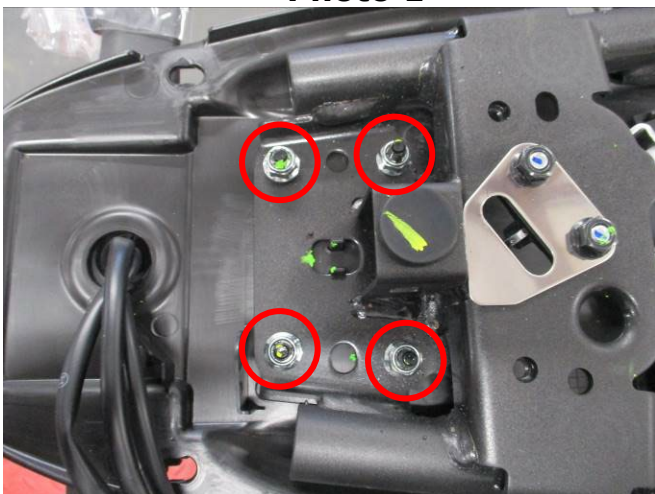

Photo 3

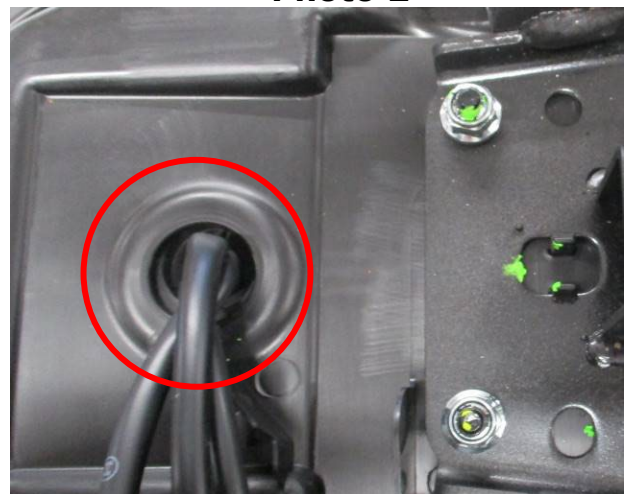

Photo 4



NOTICE DE MONTAGE

- Commencez par retirer le siège passager à l'aide de la clé.
- Retirez les boulons fixant le haut du carénage de la queue sur la moto comme indiqué sur la photo 1 et également soigneusement tout en tenant le carénage de la queue pour l'empêcher de tomber, retirez les 4 x vis noirs de la face inférieure de la queue pour séparer et enlever le carénage de la moto
- Une fois la queue a été retirée, déconnectez les 4 connecteurs mis en évidence sur la photo 2.
- Retirez les noix de verrouillage 4 X comme indiqué sur la photo 3 et retirez soigneusement le support de plaque d'immatriculation d'origine de la moto.
- Gardez les 4 x espaceurs d'origine en toute sécurité d'un côté qui sont utilisés pour monter le support de plaque d'immatriculation d'origine sur la moto.
- En vous référant au SCHÉMA D'ASSEMBLAGE ci-dessus, pré-assemblez le support R&G (ARTICLE 1) en fixant vos clignotants d'origine sur la moto avec le feu de plaque d'immatriculation fourni (ARTICLE 2) et également le bouchon en caoutchouc pour protéger les câbles (ARTICLE 8) .
- Faites passer les câbles de clignotant avec le câble LA0002 à travers le trou doublé de caoutchouc dans le support R&G comme indiqué sur la Photo 4.
- Protégez les fils LA0002 en utilisant la gaine thermo rétractable fournie (ARTICLE 6).
- Fixez le connecteur fourni pour le feu de plaque d'immatriculation (ARTICLE 3).
- Rangez tous les câbles à l'aide des serre-câbles fournis (ARTICLE 7) et des trous oblongs prévus dans le support de plaque d'immatriculation.
- Fixez le support R&G sur la moto à l'aide des boulons et des rondelles fournis (ARTICLES 4 et 5) comme indiqué dans le SCHÉMA D'ASSEMBLAGE, réutilisez les entretoises et les écrous de blocage d'origine pour le fixer sur la moto.
- Vérifiez que les clignotants et le feu de plaque d'immatriculation soient correctement câblés et fonctionnent comme ils le devraient avant de réinstaller le carénage arrière et le siège.

IMPORTANT: SI VOUS MONTEZ UNE PLAQUE D'IMMATRICULATION DE GRANDE TAILLE ET LA PLACEZ BIEN EN BAS SUR LE SUPPORT DE PLAQUE D'IMMATRICULATION, IL Y A UN RISQUE QUE LA PLAQUE D'IMMATRICULATION FRAPPE LA ROUE ARRIÈRE SOUS UNE CHARGE LOURDE ET SUR DE GROSSES BOSSES SUR LA ROUTE. IL EST DE VOTRE RESPONSABILITÉ DE VÉRIFIER CETTE POSSIBILITÉ ET DE PRENDRE DES MESURES POUR ÉVITER. NE PAS VÉRIFIER CELA POURRAIT ENTRAÎNER DES BLESSURES GRAVES.

Voir plus de produits R&G pour votre moto via ce lien :
[R&G Racing | All Products for Yamaha - XSR125 \(2021\) \(rg-racing.com\)](http://www.rg-racing.com)

ISSUE 1 – 24/02/2023 - (AO)

CONSUMER NOTICE

The catalogue description and any exhibition of samples are only broad indications of the Products and R&G may make design changes which do not diminish their performance or visual appeal and supplying them in such state shall conform to the order. The Buyer acknowledges no representation or warranty (other than as to title) has been given or will apply to the Products other than those in R&G's order or confirmation and the Buyer confirms it has chosen the Products as being of merchantable quality and suitable for its particular purposes. Where R&G fits the Products or undertakes other services it shall exercise reasonable skill and care and rectify any fault free of charge unless the workmanship has been disturbed. The Buyer is responsible for ensuring that the warranty on the motorcycle is not affected by the fitting of the Products. On return of any defective Products R&G shall at its option either supply a replacement or refund the purchase money but shall not be liable if the Products have been modified or used or maintained otherwise than in accordance with R&G's or manufacturer's instructions and good engineering practice or if the defect arises from accident or neglect. Other than identified above and subject to R&G not limiting its liability for causing death and personal injury, it shall not be liable for indirect or consequential loss and otherwise its liability shall be limited to the amounts paid by the Buyer for the Products or the fitting or service concerned. These terms do not affect the Buyer's statutory rights.

R&G Racing

Unit 1, Shelley's Lane, East Worldham, Alton, Hampshire, GU34 3AQ

Tel: +44 (0)1420 89007 Fax: +44 (0)1420 87301 www.rg-racing.com Email: info@rg-racing.com

**R&G RACING RETURNS POLICY (NON-FAULTY GOODS)**

Returns must be pre-authorized (if not pre-authorized the return will be rejected). Goods may only be returned direct to us if they were purchased direct from us (customer must prove if necessary). Otherwise to be returned to original vendor. Goods must be in re-sellable condition, in the opinion of R&G Racing. All returns are subject to a 25% restocking and handling fee (25% of the gross value exc. P&P – at the prevailing price at time of purchase). The customer must pay any and all carriage charges. No returns of discontinued products, unless within 14 days of purchase. This policy does not affect your statutory rights and does not refer to faulty goods.

R&G Racing

Unit 1, Shelley's Lane, East Worldham, Alton, Hampshire, GU34 3AQ

Tel: +44 (0)1420 89007 Fax: +44 (0)1420 87301 www.rg-racing.com Email: info@rg-racing.com



MONTAGEANLEITUNG FÜR LP0354
KENNZEICHENHALTER



ALLE KIT-TEILE SIND AUF DEN NACHFOLGENDEN SEITEN ABGEBILDET UND GEKENNZEICHNET.

DIE ABGEBILDETEN TEILE DIENEN LEDIGLICH ZUR ERKLÄRUNG.

ÜBERPRÜFEN SIE ZUERST, DASS ALLE TEILE VORHANDEN SIND.

LESEN SIE DIE MONTAGEANLEITUNG KOMPLETT DURCH, BEVOR SIE ANFANGEN.

WENN SIE BEI DER MONTAGE DIESES PRODUKTES UNSICHER SIND, BITTE EINEN UNSERER HÄNDLER KONTAKTIEREN ODER DAS KIT VON EINEM QUALIFIZIERTEN ZWEIRAD-MECHANIKER MONTIEREN LASSEN.

DIE VERPACKUNG DER TEILE STELLT NICHT DIE REIHENFOLGE DER MONTAGE DAR.

HINWEIS FÜR KITS MIT PLASTIKUNTERLEGSSCHEIBEN AN DEN SCHRAUBEN –
DIESE PLASTIK-UNTERLEGSSCHEIBEN WERDEN NICHT FÜR DEN EINBAU BENÖTIGT.

EINE DIGITALE VERSION DIESER MONTAGEANLEITUNG KANN AUF FOLGENDER SEITE HERUNTERGELADEN WERDEN:

WWW.RG-RACING.COM

R&G Racing

Unit 1, Shelley's Lane, East Worldham, Alton, Hampshire, GU34 3AQ

Tel: +44 (0)1420 89007 Fax: +44 (0)1420 87301 www.rg-racing.com Email: info@rg-racing.com



<u>SIE BENÖTIGEN FOLGENDES WERKZEUG:</u>	<u>ALLGEM. ANZUGSDREHMOMENT</u>
<ul style="list-style-type: none"> • SATZ INBUSSCHLÜSSEL • SATZ STECKSCHLÜSSEL • KREUZSCHLITZ-SCHRAUBENDREHER 	M4 SCHRAUBE = 8Nm M5 SCHRAUBE = 12Nm M6 SCHRAUBE = 15Nm M8 SCHRAUBE = 20Nm M10 SCHRAUBE = 40Nm M12 SCHRAUBE = 40Nm

LIEFERUMFANG

ARTIKEL NR.	BESCHREIBUNG	MENGE
ARTIKEL 1	TB0354 - KENNZEICHENHALTER	1
ARTIKEL 2	LA0002 - KENNZEICHENBELEUCHTUNG	1
ARTIKEL 3	CON0007 - VERBINDER FÜR KENNZEICHENBELEUCHTUNG	1
ARTIKEL 4	M6 x 1.00 x 20mm INBUSSCHRAUBE	4
ARTIKEL 5	M6 x 12mm OD UNTERLEGSCHLEIBE	4
ARTIKEL 6	666-896-18 - 180mm SCHRUMPFSCHLAUCH	1
ARTIKEL 7	CT75 - 75mm KABELBINDER	6
ARTIKEL 8	RB0010 - GUMMISTOPFEN	1
ARTIKEL 9	REFL3 - RÜCKSTRAHLER	1

R&G Racing

Unit 1, Shelley's Lane, East Worldham, Alton, Hampshire, GU34 3AQ

Tel: +44 (0)1420 89007 Fax: +44 (0)1420 87301 www.rg-racing.com Email: info@rg-racing.com



ZEICHNUNG - ZUSAMMENBAU

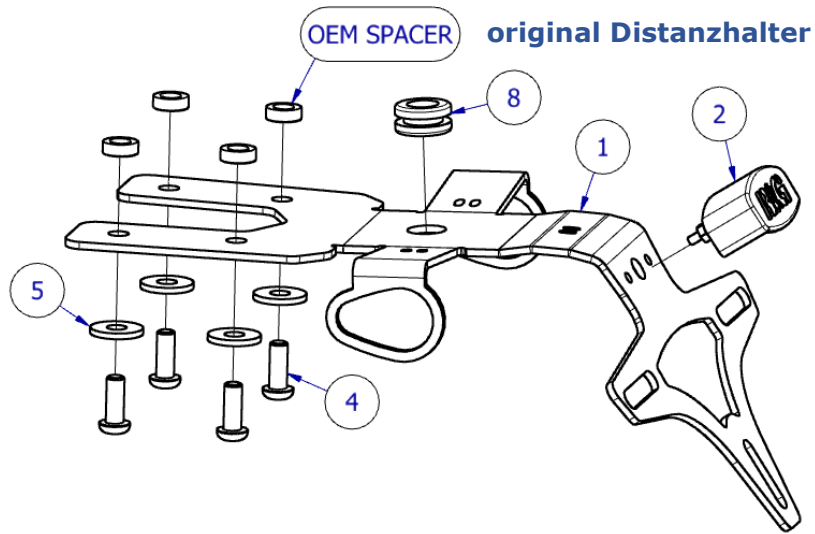

MONTAGE - ABBILDUNGEN



Abbildung 1



Abbildung 2

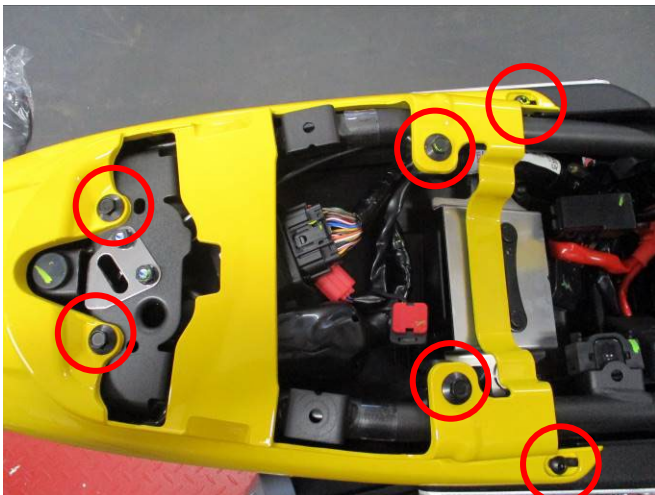

Abbildung 3

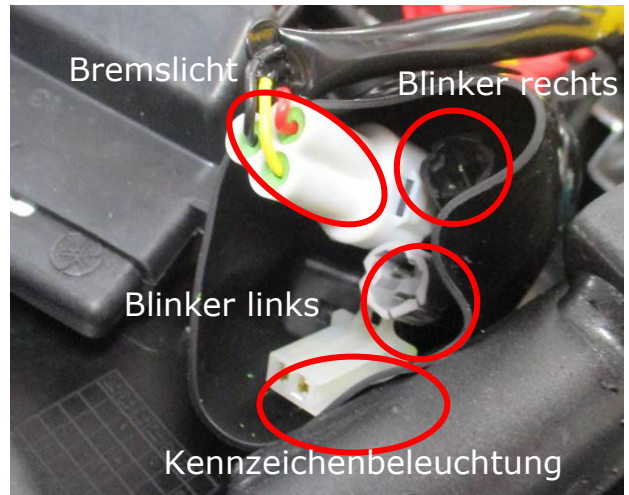

Abbildung 4

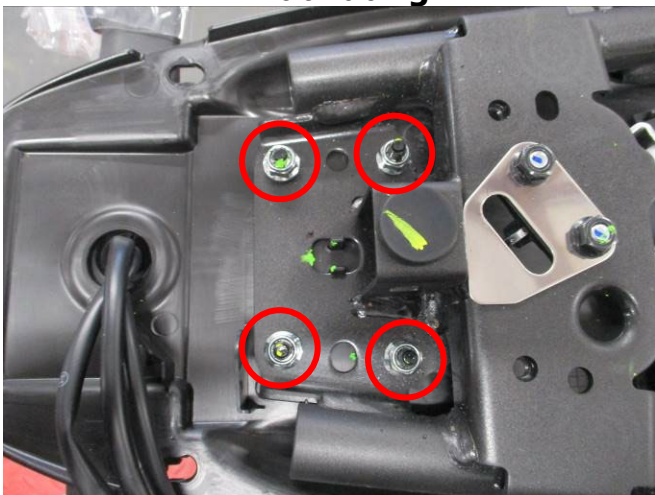

MONTAGEANLEITUNG

- Entfernen Sie den Sitz (Schlüssel wird benötigt).
- Entfernen Sie die Schrauben, die die Heckverkleidung am Motorrad oben befestigen, wie in **Abbildung 1** abgebildet. Halten Sie die Heckverkleidung fest, so dass sie runterfällt und entfernen Sie vorsichtig die 4 schwarzen Schrauben an der Unterseite des Hecks, um die Verkleidung zu splitten. Entfernen Sie anschließend die Verkleidung vom Motorrad.
- Trennen Sie nun die 4 elektrischen Verbindungen, die in **Abbildung 2** gekennzeichnet sind.
- Entfernen Sie die 4 x Sicherungsmuttern wie in **Abbildung 3** abgebildet und entfernen Sie den original Kennzeichenhalter vom Motorrad.
- Die 4 x original Distanzhalter, die zur Montage des original Kennzeichenhalters verwendet wurden, sicher zur Seite stellen.
- Gemäß der **ZEICHNUNG ZUSAMMENBAU** oben, den R&G Kennzeichenhalter (**ARTIKEL 1**) zusammenbauen, indem Sie die Originalblinker zusammen mit der mitgelieferten Kennzeichenbeleuchtung (**ARTIKEL 2**) und Gummistopfen (**ARTIKEL 8**) am Motorrad montieren.
- Die Kabel für die Blinker zusammen mit dem LA0002 Kabel durch die mit Gummi beschichteten Öffnung im R&G Kennzeichenhalter fädeln wie in **Abbildung 4** abgebildet.
- Benutzen Sie den Schrumpfschlauch vom Kit (**ARTIKEL 6**), um das LA0002 Kabel zu schützen.
- Den mitgelieferten Verbinder für die Kennzeichenbeleuchtung (**ARTIKEL 3**) anbringen.
- Benutzen Sie die Kabelbinder vom Kit (**ARTIKEL 7**) und die vorgesehenen Längsöffnungen im Kennzeichenhalter, um alle Kabel ordentlich zu verstauen.
- Sichern Sie den R&G Kennzeichenhalter am Motorrad mit den Schrauben und Unterlegscheiben vom Kit (**ARTIKEL 4 & 5**) wie in **ZEICHNUNG ZUSAMMENBAU** abgebildet und dabei die original Distanzhalter und Sicherungsmutter wiederverwenden.
- Überprüfen Sie, dass die Blinker und der Kennzeichenhalter ordnungsgemäß angeschlossen sind und funktionieren, bevor Sie die Heckverkleidung und den Sitz wieder montieren.

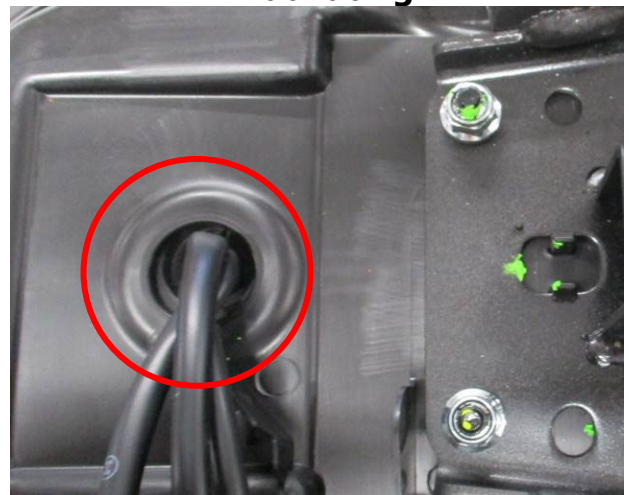
WICHTIG: WENN EIN GROSSES KENNZEICHEN ZU WEIT NACH UNTEN MONTIERT WIRD, BESTEHT BEI SCHWERER LAST ODER DURCH GROSSE BODENWELLEN EIN GERINGES RISIKO, DASS DAS KENNZEICHEN AN DAS HINTERRAD STOSSEN KANN. ES LIEGT IN IHRER VERANTWORTUNG DIES ZU ÜBERPRÜFEN UND, WENN NOTWENDIG, VORBEUGENDE MASSNAHMEN ZU ERGREIFEN. DIE NICHTBEACHTUNG DIESES SICHERHEITSHINWEISES KANN ZU SCHWEREN VERLETZUNGEN FÜHREN.

Klicken Sie hier, um weitere R&G Produkte für Ihr Motorrad zu finden:

[R&G Racing | All Products for Yamaha - XSR125 \(2021\) \(rg-racing.com\)](http://www.rg-racing.com)

AUSGABE 1 – 24/02/2023 - (AO)

CONSUMER NOTICE

The catalogue description and any exhibition of samples are only broad indications of the Products and R&G may make design changes which do not diminish their performance or visual appeal and supplying them in such state shall conform to the order. The Buyer acknowledges no representation or warranty (other than as to title) has been given or will apply to the Products other than those in R&G's order or confirmation and the Buyer confirms it has chosen the Products as being of merchantable quality and suitable for its particular purposes. Where R&G fits the Products or undertakes other services it shall exercise reasonable skill and care and rectify any fault free of charge unless the workmanship has been disturbed. The Buyer is responsible for ensuring that the warranty on the motorcycle is not affected by the fitting of the Products. On return of any defective Products R&G shall at its option either supply a replacement or refund the purchase money but shall not be liable if the Products have been modified or used or maintained otherwise than in accordance with R&G's or manufacturer's instructions and good engineering practice or if the defect arises from accident or neglect. Other than identified above and subject to R&G not limiting its liability for causing death and personal injury, it shall not be liable for indirect or consequential loss and otherwise its liability shall be limited to the amounts paid by the Buyer for the Products or the fitting or service concerned. These terms do not affect the Buyer's statutory rights.

R&G Racing

Unit 1, Shelley's Lane, East Worldham, Alton, Hampshire, GU34 3AQ

Tel: +44 (0)1420 89007 Fax: +44 (0)1420 87301 www.rg-racing.com Email: info@rg-racing.com

**R&G RACING RETURNS POLICY (NON-FAULTY GOODS)**

Returns must be pre-authorized (if not pre-authorized the return will be rejected). Goods may only be returned direct to us if they were purchased direct from us (customer must prove if necessary). Otherwise to be returned to original vendor. Goods must be in re-sellable condition, in the opinion of R&G Racing. All returns are subject to a 25% restocking and handling fee (25% of the gross value exc. P&P – at the prevailing price at time of purchase). The customer must pay any and all carriage charges. No returns of discontinued products, unless within 14 days of purchase. This policy does not affect your statutory rights and does not refer to faulty goods.

R&G Racing

Unit 1, Shelley's Lane, East Worldham, Alton, Hampshire, GU34 3AQ

Tel: +44 (0)1420 89007 Fax: +44 (0)1420 87301 www.rg-racing.com Email: info@rg-racing.com