



FITTING INSTRUCTIONS FOR LP0362BK LICENCE PLATE BRACKET



**This kit contains the items pictured and labelled over page.
Some parts may be shown for clarity of instructions only.
Do not proceed until you are sure all parts are present.
Please read all instructions before proceeding.**

**IF IN ANY DOUBT WHEN FITTING OUR PRODUCTS, CONSULT ONE OF OUR DEALERS
OR HAVE FITTED BY A QUALIFIED TECHNICIAN.**

Please note that the way the kit is packed does not necessarily represent the way of mounting to the bike.

In the event of rubber washers being used to hold components onto bolts, these rubber washers can be thrown away.

DIGITAL COPIES OF THESE INSTRUCTIONS ARE AVAILABLE FROM

WWW.RG-RACING.COM

R&G

Unit 1, Shelley's Lane, East Worldham, Alton, Hampshire, GU34 3AQ
Tel: +44 (0)1420 89007 Fax: +44 (0)1420 87301 www.rg-racing.com Email: info@rg-racing.com



<u>TOOLS REQUIRED</u>	<u>GENERAL TORQUE SETTINGS</u>
<ul style="list-style-type: none"> • Set of metric Hex keys to include 3mm, 4mm and 5mm. • Set of metric sockets and wrench. To include 6, 8 & 10mm. <ul style="list-style-type: none"> • 8mm & 10mm spanners. • Phillips screwdriver. 	M4 BOLT = 8Nm M5 BOLT = 12Nm M6 BOLT = 15Nm M8 BOLT = 20Nm M10 BOLT = 40Nm M12 BOLT = 40Nm

LEGEND

ITEM No.	DESCRIPTION	QTY
ITEM 1	TAIL TIDY BRACKET	1
ITEM 2	REAR LIGHT UNIT BRACKET	1
ITEM 3	50mm BUTTON HEAD BOLT	2
ITEM 4	30mm BUTTON HEAD BOLT	2
ITEM 5	18mm SELF TAPPING SCREW	1
ITEM 6	5mm ID WASHER	1
ITEM 7	6mm ID WASHER	4
ITEM 8	6mm ID 19mm OD WASHER	1
ITEM 9	200mm LENGTH OF HEAT SHRINK	1
ITEM 10	220mm CABLE TIE	2
ITEM 11	REFLECTOR	1

R&G

Unit 1, Shelley's Lane, East Worldham, Alton, Hampshire, GU34 3AQ

Tel: +44 (0)1420 89007 Fax: +44 (0)1420 87301 www.rg-racing.com Email: info@rg-racing.com



ASSEMBLY DIAGRAM 1

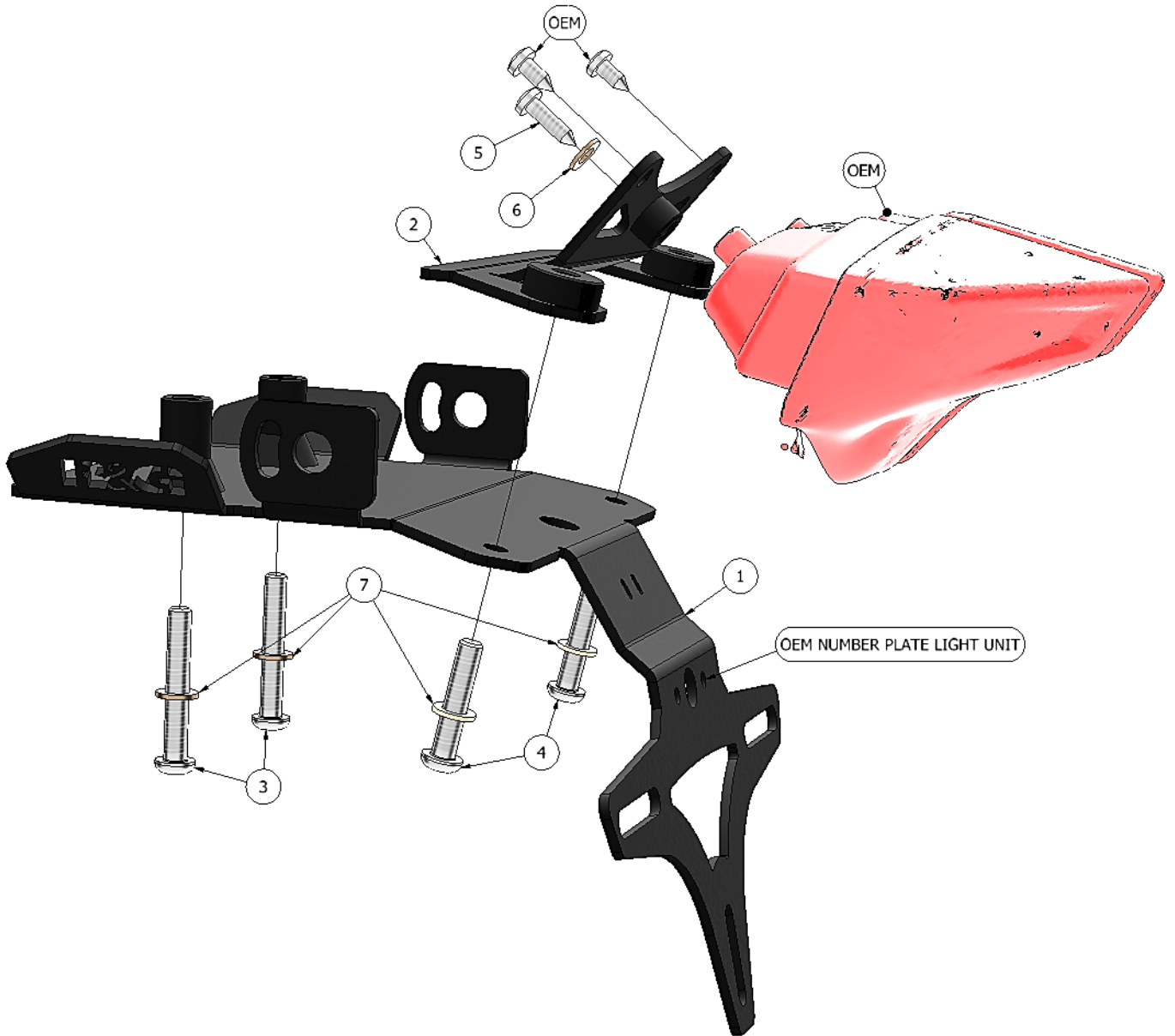

R&G

Unit 1, Shelley's Lane, East Worldham, Alton, Hampshire, GU34 3AQ

Tel: +44 (0)1420 89007 Fax: +44 (0)1420 87301 www.rg-racing.com Email: info@rg-racing.com



NUMBER PLATE LIGHT CABLE ROUTING DIAGRAM

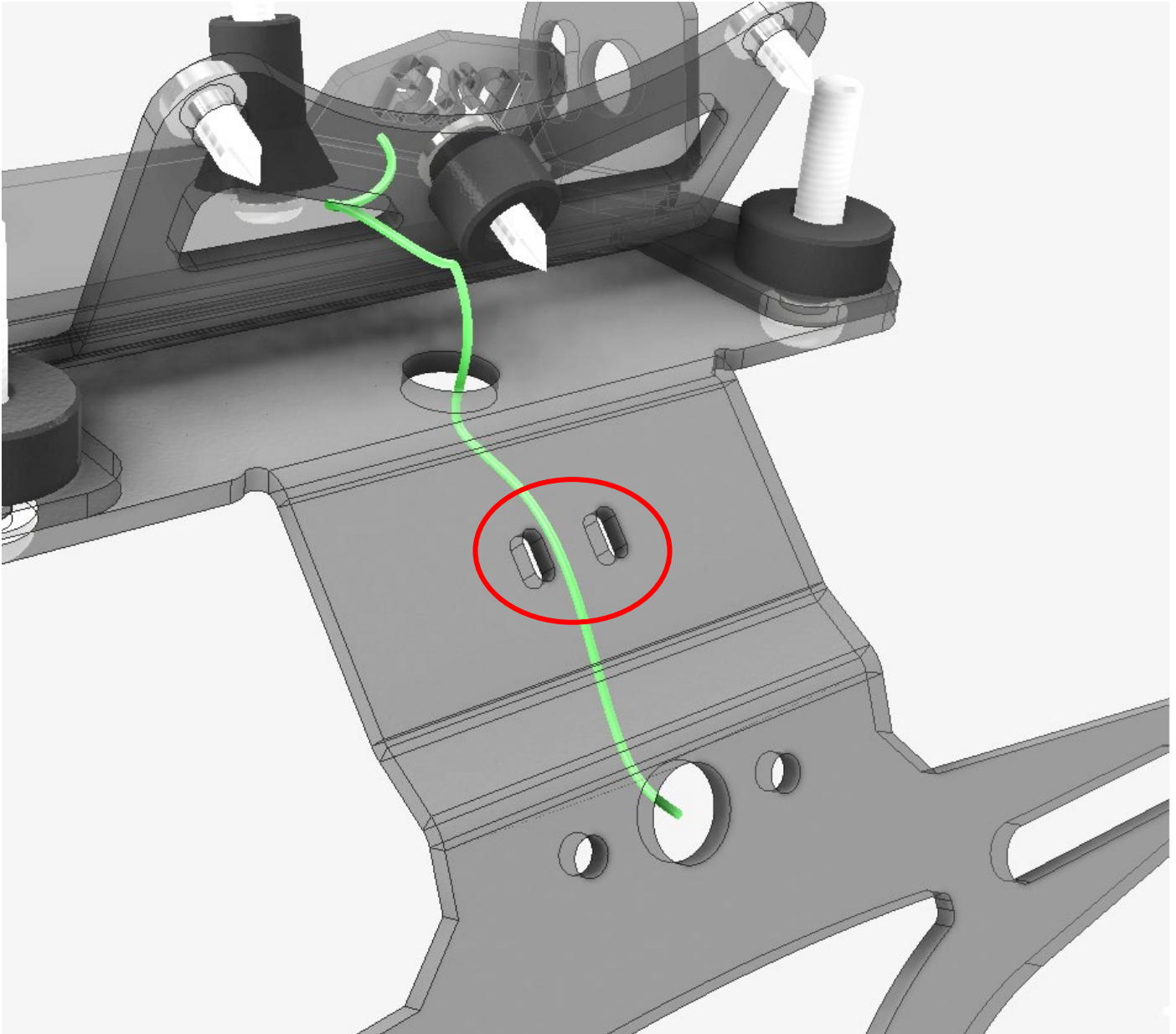

FITTING INSTRUCTIONS

Before fitting the R&G tail tidy you will need to remove some OEM parts. Below is a list of parts to be removed.

- Passenger seat unit
- OEM number plate bracket
- OEM indicators (to re-use with Tail Tidy)

R&G

Unit 1, Shelley's Lane, East Worldham, Alton, Hampshire, GU34 3AQ

Tel: +44 (0)1420 89007 Fax: +44 (0)1420 87301 www.rg-racing.com Email: info@rg-racing.com



Tail Tidy Assembly

Before assembling this product, ensure all the components within the box are correct by comparing the legend and diagrams.

1. Once the OEM tail unit has been removed and disassembled, cover the indicator and number plate light wires with heat shrink (**ITEM 9**) if required.
2. Fit the OEM rear light unit to the mounting bracket (**ITEM 2**) using the provided self tapping screw and 5mm washer (**ITEMS: 5 & 6**) to the middle mounting bolt.
3. Then fit the OEM number plate light unit to the tail tidy bracket (**ITEM 1**) using the OEM fasteners. Routing the wiring up and through the tail tidy bracket as shown in the diagram on **Page 4**, securing it with one of the provided cable ties through the slots circled in the diagram with the head of the cable tie on the underside of the tail tidy bracket.
4. Fit the OEM indicators to the indicator mounts at the side of the tail tidy bracket using the OEM fasteners and washers.
5. Once the OEM light units have been assembled with the R&G components, position the two mounting brackets together as they would be on the bike and roughly route them into a position where they won't be trapped/pinched when mounting to the bike, using the remaining cable tie if required.

TAIL TIDY FITMENT:

1. Offer up the tail tidy assembly to the motorcycle, making sure the wires are pushed into the open hole on the back end of the motorcycles where the rear light unit sits.
2. If possible connect the wiring to the OEM wiring harness before attaching the tail tidy unit. Then check the operation of the rear lights, making sure the indicators are on the correct side.

It is recommended that thread lock is used on the mounting bolts at this point

3. Once the wiring has been connected and the tail tidy is being held in position, pass the 50mm bolts with 6mm washers through the section of the tail tidy with the longer spacers, then through the regulator rectifier unit and up into the threaded holes in the subframe.

Take care not to cross thread the mounting bolts, if in doubt apply slight upward pressure to the bolt while turning **counter clockwise** until a click is heard/felt, then begin tightening.

4. Once the first two bolts have been loosely threaded in, insert the remaining 30mm bolts (with washers) (**ITEMS 4 & 7**) into the remaining two positions, up through the rear light unit bracket and into the threaded holes in the subframe.

R&G

Unit 1, Shelley's Lane, East Worldham, Alton, Hampshire, GU34 3AQ

Tel: +44 (0)1420 89007 Fax: +44 (0)1420 87301 www.rg-racing.com Email: info@rg-racing.com



(Using the same anti-cross threading technique as before)

5. The empty hole left by the OEM tail unit can be filled in using the original plastic pop clip and the larger 19mm washer (**ITEM 8**) included in the kit, push the plastic pop clip through the undertray then place the washer over the exposed end on the inside of the bike (under the seat unit)



CHECK ALL FASTENERS ARE TORQUED TO THEIR REQUIRED SETTINGS AND LIGHTING OPERATION BEFORE RIDING

IMPORTANT: IF FITTING A FULL-SIZE LICENCE PLATE AND PLACING IT LOW DOWN ON THE LICENCE PLATE MOUNT, THERE IS A POTENTIAL CHANCE THE LICENCE PLATE COULD HIT THE BACK WHEEL UNDER HEAVY LOAD AND OVER LARGE BUMPS IN THE ROAD. IT IS YOUR RESPONSIBILITY TO CHECK FOR THIS POSSIBILITY AND TAKE AVOIDING ACTION. FAILURE TO CHECK THIS COULD RESULT IN SERIOUS INJURY.

ISS 1 01/09/2023 (TB)

CONSUMER NOTICE

The catalogue description and any exhibition of samples are only broad indications of the Products and R&G may make design changes which do not diminish their performance or visual appeal and supplying them in such state shall conform to the order. The Buyer acknowledges no representation or warranty (other than as to title) has been given or will apply to the Products other than those in R&G's order or confirmation and the Buyer confirms it has chosen the Products as being of merchantable quality and suitable for its particular purposes. Where R&G fits the Products or undertakes other services it shall exercise reasonable skill and care and rectify any fault free of charge unless the workmanship has been disturbed. The Buyer is responsible for ensuring that the warranty on the motorcycle is not affected by the fitting of the Products. On return of any defective Products R&G shall at its option either supply a replacement or refund the purchase money but shall not be liable if the Products have been modified or used or maintained otherwise than in accordance with R&G's or manufacturer's instructions and good engineering practice or if the defect arises from accident or neglect. Other than identified above and subject to R&G not limiting its liability for causing death and personal injury, it shall not be liable for indirect or consequential loss and otherwise its liability shall be limited to the amounts paid by the Buyer for the Products or the fitting or service concerned. These terms do not affect the Buyer's statutory rights.

R&G RACING RETURNS POLICY (NON-FAULTY GOODS)

Returns must be pre-authorized (if not pre-authorized the return will be rejected). Goods may only be returned direct to us if they were purchased direct from us (customer must prove if necessary). Otherwise to be returned to original vendor. Goods must be in re-sellable condition, in the opinion of R&G Racing. All returns are subject to a 25% restocking and handling fee (25% of the gross value exc. P&P – at the prevailing price at time of purchase). The customer must pay any and all carriage charges. No returns of discontinued products, unless within 14 days of purchase. This policy does not affect your statutory rights and does not refer to faulty goods.

R&G

Unit 1, Shelley's Lane, East Worldham, Alton, Hampshire, GU34 3AQ

Tel: +44 (0)1420 89007 Fax: +44 (0)1420 87301 www.rg-racing.com Email: info@rg-racing.com