



FITTING INSTRUCTIONS FOR LP0363 LICENCE PLATE BRACKET



**This kit contains the items pictured and labelled over page.
Some parts may be shown for clarity of instructions only.
Do not proceed until you are sure all parts are present.
Please read all instructions before proceeding.**

**IF IN ANY DOUBT WHEN FITTING OUR PRODUCTS, CONSULT ONE OF OUR DEALERS
OR HAVE FITTED BY A QUALIFIED TECHNICIAN.**

Please note that the way the kit is packed does not necessarily represent the way of mounting to the bike.

In the event of rubber washers being used to hold components onto bolts, these rubber washers can be thrown away.

DIGITAL COPIES OF THESE INSTRUCTIONS ARE AVAILABLE FROM

WWW.RG-RACING.COM

R&G

Unit 1, Shelley's Lane, East Worldham, Alton, Hampshire, GU34 3AQ
Tel: +44 (0)1420 89007 Fax: +44 (0)1420 87301 www.rg-racing.com Email: info@rg-racing.com



<u>TOOLS REQUIRED</u>	<u>GENERAL TORQUE SETTINGS</u>
<ul style="list-style-type: none"> • Set of metric Hex keys to include 3mm, 4mm and 5mm. • Set of metric sockets and wrench. To include 6, 8 & 10mm. <ul style="list-style-type: none"> • 8mm & 10mm spanners. • Phillips screwdriver. 	M4 BOLT = 8Nm M5 BOLT = 12Nm M6 BOLT = 15Nm M8 BOLT = 20Nm M10 BOLT = 40Nm M12 BOLT = 40Nm

LEGEND

ITEM No.	DESCRIPTION	QTY
ITEM 1	TB0363 PART 1 (TAIL TIDY BRACKET 2mm STAINLESS)	1
ITEM 2	TB0363 PART 2 (NUMBER PLATE BRACKET 3mm ALUMINIUM)	1
ITEM 3	TB0363 PART 3 (SPACER PLATE 4mm ALUMINIUM)	1
ITEM 4	LA0007 (BREAK LIGHT ASSEMBLY)	1
ITEM 5	LH0005 (LIGHT HOUSING / COVER FITTING KIT)	1
ITEM 6	CON0004 (BULLET CONNECTORS)	2
ITEM 7	CON0040 (BRAKE/ NUMBER PLATE CONNECTOR)	1
ITEM 8	(M6x1.0x16mm BUTTON HEAD BOLT)	4
ITEM 9	(M5x0.8x16mm COUNTERSUNK BOLT)	4
ITEM 10	M5x10mm (FLAT WASHER)	4
ITEM 11	M6x12mm (FLAT WASHER)	6
ITEM 12	M5X0.8 (NYLOC NUT)	4
ITEM 13	RB0004 (RUBBER BUNG)	1
ITEM 14	666-896/20 (200mm LENGTH OF 666-896 (HEAT-SHRINK))	2
ITEM 15	CT75BK (2.5mm WIDE x 75mm LONG CABLE TIES (BLACK))	3
ITEM 16	REFL3 (REFLECTOR)	1

R&G

Unit 1, Shelley's Lane, East Worldham, Alton, Hampshire, GU34 3AQ

Tel: +44 (0)1420 89007 Fax: +44 (0)1420 87301 www.rg-racing.com Email: info@rg-racing.com



ASSEMBLY DIAGRAM 1

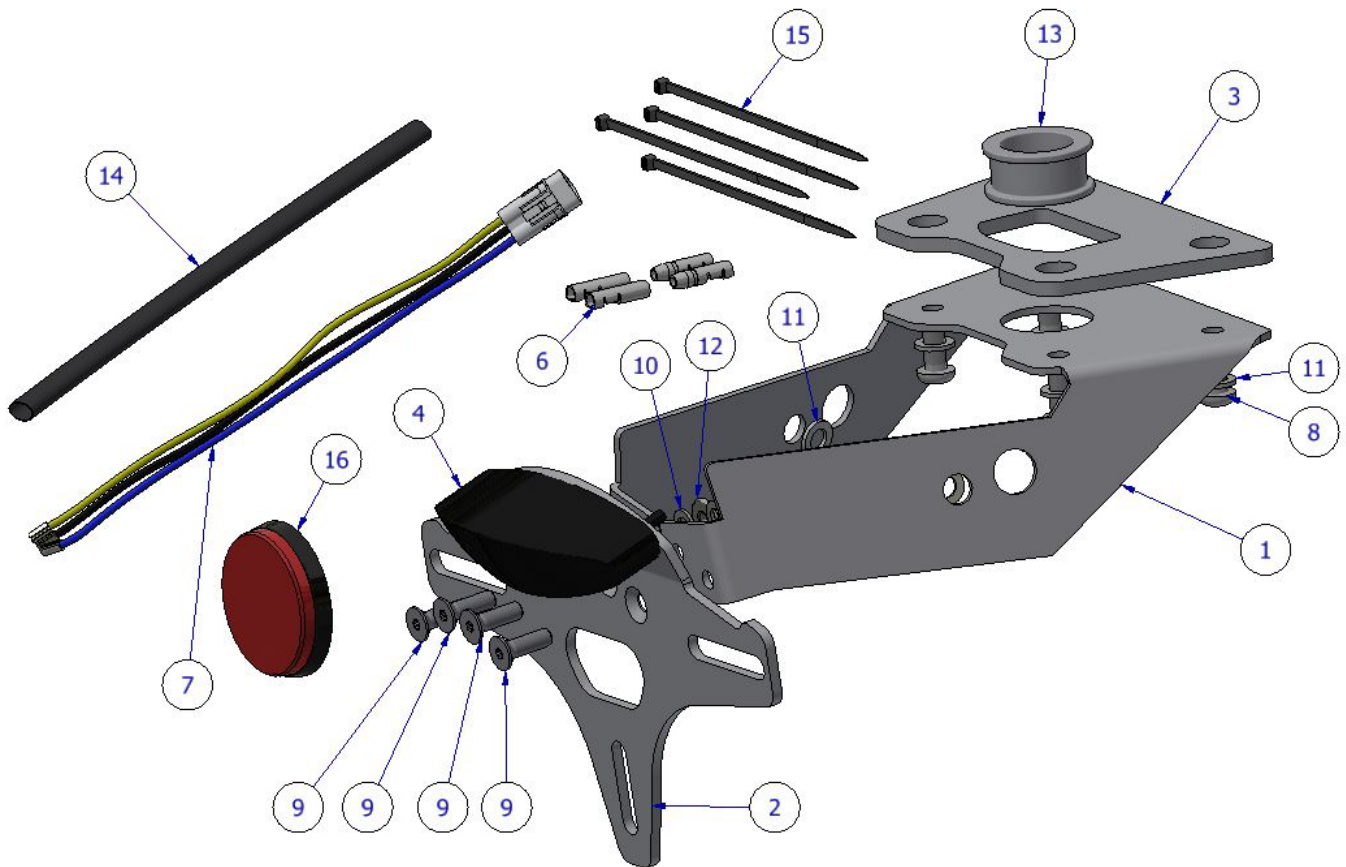

FITTING INSTRUCTIONS

Before fitting the R&G tail tidy you will need to remove some OEM parts. Below is a suggested list of parts to be removed.

- Seat
- Unplug indicators and number plate light.
- OEM number plate bracket
- OEM indicators (re-use all components with Tail Tidy)
- Unplug indicator and number plate light wires

R&G

Unit 1, Shelley's Lane, East Worldham, Alton, Hampshire, GU34 3AQ

Tel: +44 (0)1420 89007 Fax: +44 (0)1420 87301 www.rg-racing.com Email: info@rg-racing.com



Tail Tidy Assembly

Before assembling this product, ensure all the components within the box are correct by comparing the **legend** and **diagrams**.

1. To start the assembly process, connect the tail tidy bracket (**ITEM 1**) and the number plate bracket (**ITEM 2**) together using x4 of (**ITEM 9**), (**ITEM 10**) and (**ITEM 12**). As shown in **DIAGRAM 1**.
2. Before the Rubber bung (**ITEM 13**) can be mounted, you will need to cut a small cross into the centre of the flat face to make an access hole for the wires to enter.
3. Now place the Rubber Grommet (**ITEM 13**) through the Licence plate bracket (**ITEM 1**) with the hole facing towards the top of the bike, as shown in **DIAGRAM 1**.
4. Apply the Heat shrink (**ITEM 14**) to the number plate light (**ITEM 4**) wires.
5. Mount the break light assembly (**ITEM 4**) to the number plate bracket (**ITEM 2**) using the supplied nuts and bolts.

Mounting To the Bike

6. Now the assembly is ready to be mounted to the motorbike. To do so you will need x4 (**ITEM 8**) & (**ITEM 11**) and the spacer plate (**ITEM 3**). Use **DIAGRAM 1** to assist with where each ITEM goes.

MAKE SURE TO SLOT x1 WASHER (ITEM 11) ONTO ALL BOLTS (ITEM 8) BEFORE MOUNTING.

7. Now place the Tail tidy into the same mounting holes as the OEM number plate bracket and tighten the bolts to the correct torques settings using the **GENERAL TORQUE SETTINGS** on **page 2**. **Ensure the spacer plate has been installed.**
8. Fit the OEM indicators into the new Tail tidy assembly and place the wires through the rubber bung (**ITEM 13**). Then plug them back into the OEM connectors.

ENSURE INDICATORS ARE CORRECT WAY AROUND.

9. Final step, re-install all OEM parts except from the OEM Number Plate Bracket. (The reflector within the kit in case a new number plate is required).

IMPORTANT: IF FITTING A FULL-SIZE LICENCE PLATE AND PLACING IT LOW DOWN ON THE LICENCE PLATE MOUNT, THERE IS A POTENTIAL CHANCE THE LICENCE PLATE COULD HIT THE BACK WHEEL UNDER HEAVY LOAD AND OVER LARGE BUMPS IN THE ROAD. IT IS YOUR RESPONSIBILITY TO CHECK FOR THIS POSSIBILITY AND TAKE AVOIDING ACTION. FAILURE TO CHECK THIS COULD RESULT IN SERIOUS INJURY.

ISSUE 3 28/06/2023 (JH)

R&G

Unit 1, Shelley's Lane, East Worldham, Alton, Hampshire, GU34 3AQ
Tel: +44 (0)1420 89007 Fax: +44 (0)1420 87301 www.rg-racing.com Email: info@rg-racing.com

**CONSUMER NOTICE**

The catalogue description and any exhibition of samples are only broad indications of the Products and R&G may make design changes which do not diminish their performance or visual appeal and supplying them in such state shall conform to the order. The Buyer acknowledges no representation or warranty (other than as to title) has been given or will apply to the Products other than those in R&G's order or confirmation and the Buyer confirms it has chosen the Products as being of merchantable quality and suitable for its particular purposes. Where R&G fits the Products or undertakes other services it shall exercise reasonable skill and care and rectify any fault free of charge unless the workmanship has been disturbed. The Buyer is responsible for ensuring that the warranty on the motorcycle is not affected by the fitting of the Products. On return of any defective Products R&G shall at its option either supply a replacement or refund the purchase money but shall not be liable if the Products have been modified or used or maintained otherwise than in accordance with R&G's or manufacturer's instructions and good engineering practice or if the defect arises from accident or neglect. Other than identified above and subject to R&G not limiting its liability for causing death and personal injury, it shall not be liable for indirect or consequential loss and otherwise its liability shall be limited to the amounts paid by the Buyer for the Products or the fitting or service concerned. These terms do not affect the Buyer's statutory rights.

R&G RACING RETURNS POLICY (NON-FAULTY GOODS)

Returns must be pre-authorized (if not pre-authorized the return will be rejected). Goods may only be returned direct to us if they were purchased direct from us (customer must prove if necessary). Otherwise to be returned to original vendor. Goods must be in re-sellable condition, in the opinion of R&G Racing. All returns are subject to a 25% restocking and handling fee (25% of the gross value exc. P&P – at the prevailing price at time of purchase). The customer must pay any and all carriage charges. No returns of discontinued products, unless within 14 days of purchase. This policy does not affect your statutory rights and does not refer to faulty goods.

R&G

Unit 1, Shelley's Lane, East Worldham, Alton, Hampshire, GU34 3AQ

Tel: +44 (0)1420 89007 Fax: +44 (0)1420 87301 www.rg-racing.com Email: info@rg-racing.com