



FITTING INSTRUCTIONS FOR SP0029 SWINGARM-PROTECTORS
HARLEY DAVIDSON XR1200X



THIS KIT CONTAINS THE ITEMS PICTURED AND LABELLED BELOW.
DO NOT PROCEED UNTIL YOU ARE SURE ALL PARTS ARE PRESENT.

Please note that the way the kit is packed does not necessarily represent the way of mounting to the bike.

THE PARTS SHOWN MAY BE REPRESENTATIVE ONLY (FOR CLARITY OF INSTRUCTIONS ONLY)

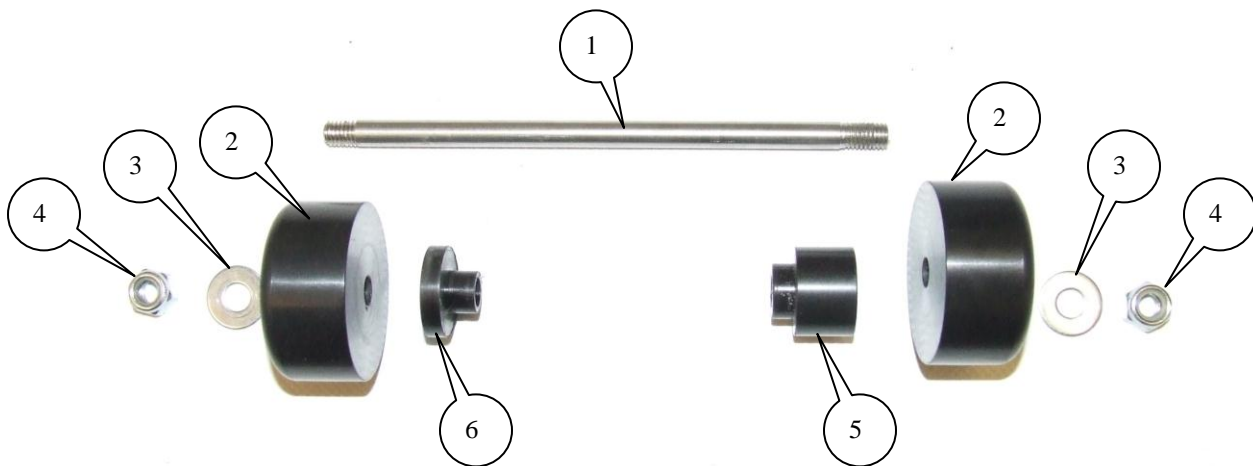

LEGEND

- ITEM 1 = SPINDLE BAR (SB079 APPROX 446mm LONG) (x1)
- ITEM 2 = CRASH PROTECTORS (B0442 M8 (8mm INTERNAL DIAMETER)) (x2).
- ITEM 3 = M8 WASHERS (19mm OUTSIDE DIAMETER) (x2).
- ITEM 4 = M8 NYLOC NUTS (x2).



ITEM 5 = RIGHT-HAND SPACER (S0428) (x1).
ITEM 6 = LEFT-HAND SPACER (S0427) (x1).

Please note that in cases where kits are packed with rubber washers holding the components onto the bolt – *the rubber washers should be thrown away!*

TOOLS REQUIRED

- TWO 13mm A/F SOCKETS AND WRENCHES.

FITTING INSTRUCTIONS

- PLACE THE LARGER SPACER (S0428) INTO RIGHT-HAND REAR WHEEL SPINDLE.
- FIT THE M8 NYLOC NUT AND THE 8mm WASHER TO THE SPINDLE-BAR (SB079) SO THE SPINDLE PROTRUDES APPROXIMATELY 2mm FROM NUT.
- FEED THE SPINDLE BAR ASSEMBLY THROUGH ONE OF THE CRASH PROTECTORS (B0422 M8) SO THE NUT GOES INTO THE COUNTER BORE.
- FEED THIS ASSEMBLY THROUGH THE REAR WHEEL SPINDLE FROM RIGHT TO LEFT (THROUGH SPACER ALREADY FITTED).
- PLACE THE REMAINING SMALLER STEPPED SPACER (S0427) OVER EXPOSED END OF THE SPINDLE BAR ON LEFT HAND SIDE.
- PLACE THE REMAINING CRASH PROTECTOR (B0422 M8) OVER EXPOSED END OF THE SPINDLE BAR ON LEFT HAND SIDE (AGAINST SPACER JUST FITTED).
- PLACE M8 WASHER AND M8 NYLOC NUT ONTO EXPOSED THREAD OF SPINDLE BAR.
- TIGHTEN UNTIL BOTH NUTS ARE ENGAGED IN NYLON AND EQUAL AMOUNTS PROTRUDE FROM EITHER SIDE. DO NOT OVER-TIGHTEN—THE NYLOC NUTS WILL HOLD IT TIGHT.

ISSUE 1 23/02/2011

CONSUMER NOTICE

The catalogue description and any exhibition of samples are only broad indications of the Products and R&G may make design changes which do not diminish their performance or visual appeal and supplying them in such state shall conform to the order. The Buyer acknowledges no representation or warranty (other than as to title) has been given or will apply to the Products other than those in R&G's order or confirmation and the Buyer confirms it has chosen the Products as being of merchantable quality and suitable for its particular purposes. Where R&G fits the Products or undertakes other services it shall exercise reasonable skill and care and rectify any fault free of charge unless the workmanship has been disturbed. The Buyer is responsible for ensuring that the warranty on the motorcycle is not affected by the fitting of the Products. On return of any defective Products R&G shall at its option either supply a replacement or refund the purchase money but shall not be liable if the Products have been modified or used or maintained otherwise than in accordance with R&G's or manufacturer's instructions and good engineering practice or if the defect arises from accident or neglect. Other than identified above and subject to R&G not limiting its liability for causing death and personal injury, it shall not be liable for indirect or consequential loss and otherwise its liability shall be limited to the amounts paid by the Buyer for the Products or the fitting or service concerned. These terms do not affect the Buyer's statutory rights.

R&G RACING RETURNS POLICY (NON-FAULTY GOODS)

Returns must be pre-authorized (if not pre-authorized the return will be rejected). Goods may only be returned direct to us if they were purchased direct from us (customer must prove if necessary). Otherwise to be returned to original vendor. Goods must be in re-sellable condition, in the opinion of R&G Racing. All returns are subject to a 25% restocking and handling fee (25% of the gross value exc. P&P – at the prevailing price at time of purchase). The customer must pay any and all carriage charges. No returns of discontinued products, unless within 14 days of purchase. This policy does not affect your statutory rights and does not refer to faulty goods.

R&G Racing

Unit 1, Shelley's Lane, East Worldham, Alton, Hampshire, GU34 3AQ

Tel: +44 (0)1420 89007 Fax: +44 (0)1420 87301 www.rg-racing.com Email: info@rg-racing.com



FRANCE
INSTRUCTIONS DE MONTAGE DE LA PROTECTION
SP0029 HARLEY DAVIDSON XR1200X

Merci de noter que les pièces assemblées dans l'emballage ne sont pas nécessairement dans le sens du montage à réaliser sur la moto. Enlever le tube en plastique transparent si celui-ci est présenté dans l'emballage

LEGENDE

- Art. 1 = Axe (SB079 APPROX 446mm) (x1)
- Art. 2 = Tampons (B0442 M8 (Dia. Int. 8mm)) (x2).
- Art. 3 = Rondelles M8 (Dia. Ext. 19mm) (x2).
- Art. 4 = Ecrus autobloquants M8 (x2).
- Art. 5 = Entretoise Droite (S0428) (x1).
- Art. 6 = Entretoise Gauche (S0427) (x1).

OUTILS NECESSAIRES

- 2 Clefs de 13 mm à douilles

INSTRUCTIONS DE MONTAGE

- Glisser l'entretoise la plus épaisse dans l'axe de roue arrière côté droit de la moto. (le diamètre le plus petit sera positionné à l'intérieur de l'axe de roue).
- Visser complètement un écrou M8 sur l'axe R&G. L'axe devra ressortir d'environ 2 mm de l'écrou.
- Glisser une rondelle sur l'axe contre l'écrou autobloquant.
- Passer la barre R&G à travers l'un des tampons R&G et glisser le tout à travers l'entretoise positionnée sur le côté droit de la moto.
- Glisser l'entretoise restante (S0427) sur le côté gauche de l'axe R&G. (le diamètre le plus petit de l'entretoise, sera positionné vers l'intérieur de l'axe de roue arrière).
- Glisser le tampon restant sur l'axe contre l'entretoise R&G.
- Glisser une rondelle M8 et visser l'écrou M8 restant sur l'axe.
- Serrer les deux écrous simultanément. **Ne pas serrer trop fortement, en effet les écrous autobloquants garderont le montage en place.**